

AQUASURE

DASH SERIES

DRINKING WATER SYSTEM
OWNER'S MANUAL

FOR MODEL NO.
AS-D100MCB
AS-D100CER
AS-D200UF



TABLE OF CONTENT

2	INSPECTION & PREPARATION
2	I. Be Familiar with the System Before Installation
3	II. System Operation Parameter and Installation checklist
4	INSTALLING THE SYSTEM
4	STEP 1. Remove Aerator
4	STEP 2. Determine the type of threads
4	STEP 3. Screw on the diverter valve
4	STEP 4. Turn on the Water & Rotate the Lever
4	STEP 5. Connecting the filter replacement indicator circuit plug
5	SYSTEM START-UP
6	FILTER-REPLACEMENT INSTRUCTION
8	LIMITED PRODUCT WARRANTY



You can also visit online for system installation tutorial.
<http://www.aquasureusa.com/support>

WELCOME

Thank you for choosing Aquasure. Before you start using your Aquasure drinking water system, take a few minutes to become familiar with the basics.

Filter replacement

Be sure to change your Aquasure water filters according to the recommended filter replacement schedule. This helps keep your Aquasure drinking water system running in top condition. See page 6

INSPECTION & PREPARATION

I. Be Familiar with the System Before Installation



IMPORTANT! Please read the entire manual and become familiar with instructions and parts needed before proceeding with the installation.

Inspect the System

Please take the system and all the components out of the box. Inspect the system and all the connection fittings carefully, make sure nothing is damaged during shipping. If any part is cracked or broken, please do not proceed with the installation and contact Aquasure or your distributor for an exchange or diagnosis.

Recommended Tool List for System Installation

- Pliers
- Phillips screwdrivers
- Rag

System Components Breakdown

AS-D100MCB includes

- AF-D05MCB Filter
- AS-D100 Housing
- AAA Battery X 2



AS-D100CER includes

- AF-D05CER
- AS-D100 Housing
- AAA Battery X 2



AS-D200UF includes

- AF-D5SED
- AF-D001UF
- AS-D200 Housing
- AAA Battery X 2



Installation Kit Includes

- Diverter Kit
- Thread Adapter
- O-rings



II. System Operation Parameter and Installation checklist

IMPORTANT! The following condition for feed water supply must be met or warranty will be void and manufacturer assumes no responsibility for damage to system or property.

1. Water Temperature Parameter

- Maximum: 105° F (40.6° C)
- Minimum: 33° F (0.55° C)

WARNING: Do not allow the system to freeze, the filter always contains water and will be destroyed if frozen. Do not plumb system to hot water, The tubing will expand or burst, and filter will be destroyed which will void warranty and manufacturer's responsibility.

2. Water Pressure Parameter

- Maximum: 80 PSI (5.6 kg/cm²)
- Minimum: 20 PSI (1.41 kg/cm²)

3. Water Condition Parameter

- Turbidity: <5 NTU
- pH: 4 - 11
- Hardness: < 7 grains per gallon (< 120 ppm)
- Sulfide, Iron Manganese: < 0.01 ppm
- Chlorine: < 2 ppm
- Total Dissolved Solids (TDS): < 1,000 ppm

4. Pre-install environment checklist

- Do not use with water that is microbiologically unsafe or of unknown quality without adequate disinfection before or after the system.

INSTALLING THE SYSTEM

i **IMPORTANT!** The included adapters are designed to fit most faucets. To create a tight seal, you may need to use the gasket from your faucet's aerator in addition to the washers included with the adapters. If the adapters do not fit, consult your local plumbing or hardware supplier for assistance in obtaining the correct thread adapter.

STEP 1. Removes Aerator from faucet on which filter will be installed.

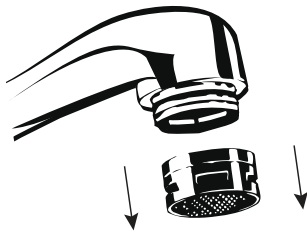

STEP 2. Determine the type of threads on your faucet

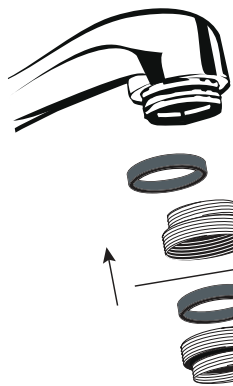

External Threads:
No adapter should be needed.

Internal Threads:
Through trial and error, select the proper adapter and washer to screw into faucet and tighten manually.

STEP 3. Screw the diverter valve onto the faucet, turning the swivel collar to tighten

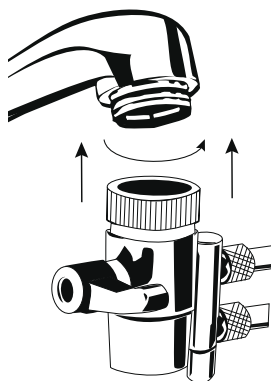

Make certain that gasket (already installed in diverter valve) is positioned securely between the diverter valve and the faucet (or adapter). Rotate diverter valve stem to desired positions. Swivel collar may need to be re-tightened. Place assembly conveniently next to sink.

STEP 4. Turn on water and rotate lever

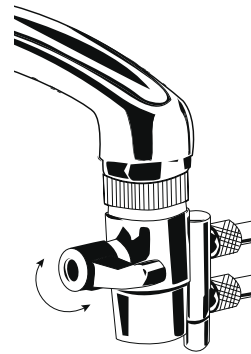

This causes the water to flow through the filter before exiting the faucet. To stop water flow to filter, rotate the lever back to turn water off.

STEP 5. Connecting the filter replacement indicator circuit plug

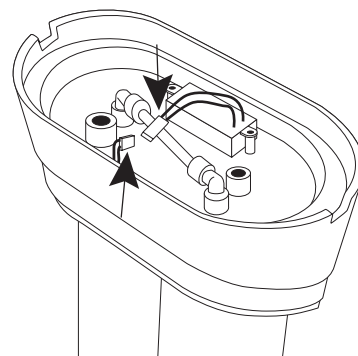

After making sure the faucet adapter are connected properly, connect the two pin circuit plug to activate the filter replacement timer.

The LED in front of the system will blink a few times indicating that the timer has been activated.

SYSTEM START-UP

- Once the system has been connected, activate the systems filter cartridges by running water through the system for 3 - 5 minutes.
- Immediately check entire water filtration system for leaks. If you notice any leaks, turn off the faucet and fix the leak.
- Upon first use, you may notice some carbon fines. This is normal and will disappear during the 3 - 5 minute filter cartridge activation.

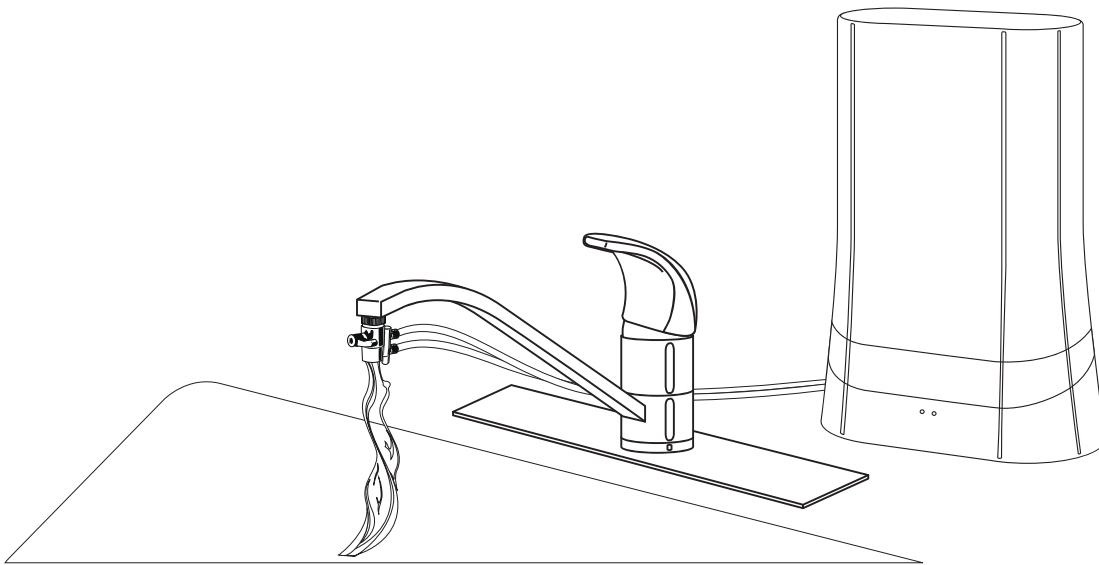

CAUTION! If installing the unit in new construction, ensure that house plumbing is flushed thoroughly before opening the water supply valve.

Note:

- A drinking water cartridge may contain carbon fines (Very fine black powder). After installation, flush the cartridge for 5 minutes to remove the fines before using the water.
- It is recommended that you run the tap at least 20 seconds prior to using water for drinking or cooking purposes.
- During initial use, your water may appear cloudy. This cloudiness is caused by air that has been trapped in the cartridge. If you let the water sit for 5 minutes in a glass, you will notice the cloudiness disappear from the bottom up. This phenomenon is not harmful.

FILTER REPLACEMENT INSTRUCTION

STEP 1. OPEN SYSTEM

Remove cover and band

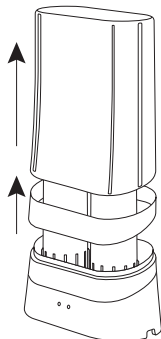

STEP 2. FLIP SYSTEM

Flip system and place in small bucket

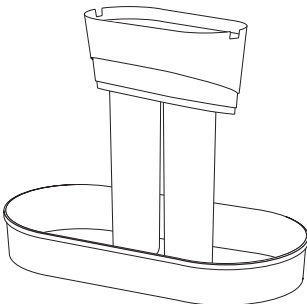

STEP 3. UNSCREW HOUSING

Remove cover and band

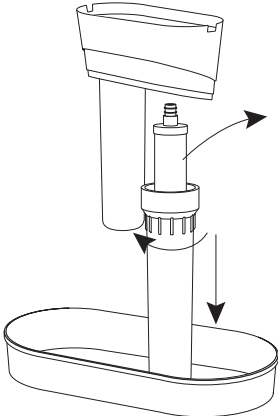

STEP 4. REPLACE FILTER

Replace with new filter

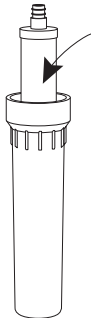

STEP 5. SCREW HOUSING

Screw back housing

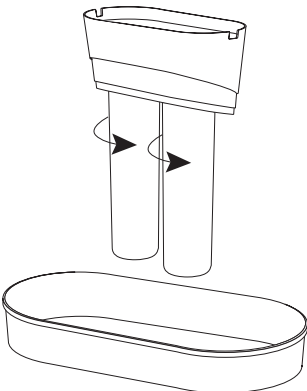

STEP 6. UNPLUG BATTERY

Unplug battery connector

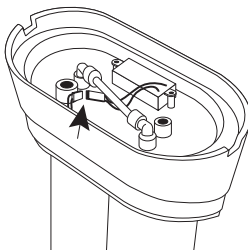

STEP 7. UNSCREW & REPLACE

Unscrew battery case and replace battery

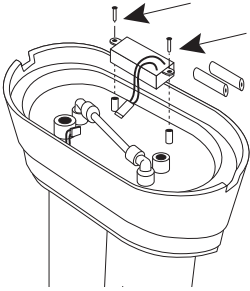

STEP 8. SCREW & PLUG

Screw back battery case and plug battery connector

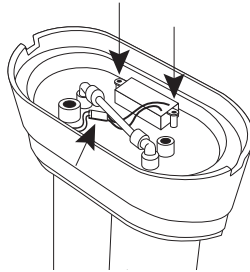

STEP 9. FLIP OVER & CLOSE

Flip system and replace band and cover

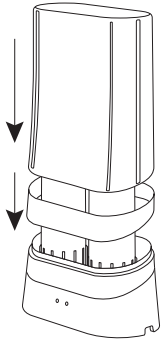

STEP 10. SYSTEM START-UP

Repeat system start-up and flushing steps.

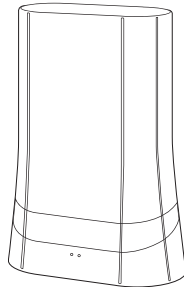

LIMITED PRODUCT WARRANTY

Scope:

Aquasure takes pride in selling a superb line of products, including this drinking water system ("Product"). As such, Aquasure expressly warrants to the original purchaser that, for a period of one (1) year from the date of purchase, the product will be reasonably free of defects in materials and workmanship. Within that one (1) year period from the original purchase, Aquasure will, at its option, repair or replace the Product without charge, or refund the cost of the product, if the Product fails or does not perform as warranted solely due to a manufacturing defect within the warranty period, subject to the limitations and exclusions set forth in this Limited Product Warranty. This Limited Product warranty only applies when the Product is used, stored, handled, fabricated and/or installed in the manner recommended by Aquasure in the Installation Instruction & Owner's Manual ("Manual").

Repair or Replacement:

Repair or replacement during this one (1) year warranty shall include reasonable labor charges necessary to repair or replace the defective product, but shall not include freight charges or any other local labor charges from third parties other than Aquasure, unless Aquasure expressly approves such charges in writing. During the entire one (1) year warranty, Aquasure obligation to repair or replace shall further be limited to repair or replacement with the styles, models, products, colors, etc. of the Product that are available at the time of the repair or replacement, and shall be limited to the repair or replacement of only the specific Product that fails due to a manufacturing defect. Any repaired or replaced product shall also remain subject to the original one (1) year warranty from the date of the original purchase, and any repair or replacement shall not extend the original warranty period in any manner or start a new warranty period.

Conditions of Validity of this Limited Product Warranty:

Even though the Product has extremely high endurance for operating conditions such as pH, maximum TDS, temperature, and optimum water pressure, THIS LIMITED PRODUCT WARRANTY SHALL ONLY BE VALID IF: The replaceable filters and membrane are changed and maintained on a regular basis as directed in the Manual. Moreover, depending on local water input water quality, regular maintenance may need to be increased.

Non-Covered Defects:

THIS LIMITED PRODUCT WARRANTY DOES NOT COVER DEFECTS CAUSED BY:

1. Improper storage, installation, maintenance, handling, use and/or alterations of the Product, including, but not limited to, noncompliance with the installation, maintenance and standard operation conditions stated in the Manual and this Limited Product Warranty.
2. Unreasonable use, unintended use, or misuse of the Product for something other than its intended purpose as a drinking water system.
3. Use of replacement parts, filters, membranes or other accessories that are not sold or manufactured by Aquasure for use with this particular Product.
4. Damage not resulting from manufacturing defects that occur while the Product is in the original purchaser's possession.
5. Installation of the Product with known or visible manufacturing defects at the time of installation.
6. Damage caused by freezing, flood, fire or Act of God.

Condition that render this limited product warranty void

THIS LIMITED PRODUCT WARRANTY SHALL BE VOID IF:

1. The Product is not operated in compliance with normal municipal water conditions for which the particular model of this Product is intended.
2. The person seeking to invoke the warranty is not the original purchaser. That is, this Limited Product Warranty only extends to original purchasers.
3. The product is purchased used. That is, this Limited Product Warranty only covers new products.
4. The Product is purchased from someone other than Aquasure or one of Aquasure's authorized dealers. This is because, unless the Product was sold by Aquasure or one of its authorized dealers, Aquasure cannot verify or guarantee the integrity or authenticity of the Product.

General Conditions

The warranties set forth herein are the only warranties made by Aquasure in connection with the product. Aquasure cannot and does not make any implied or express warranties with respect to the product, and disclaims all other warranties, including, but not limited to, any warranty of merchantability or fitness for a particular purpose. Products sold by Aquasure are sold only to the specifications specifically set forth by Aquasure in writing. Other than the limited product warranty set forth herein, Aquasure makes no other warranties, express or implied. Aquasure's sole obligation under this warranty shall be repair or replacement of a non-conforming product or parts of the product, or at the option of Aquasure, return of the product and a refund of the purchase price. Buyer assumes all risk whatsoever as to the result of the use of the product purchased, whether used singularly or in combination with any other products or substances.

No claim by the buyer/owner of any kind, including claims for indemnification, shall be greater in amount than the purchase price of the products in respect to which damages are claimed. In no event shall Aquasure be liable to buyer/owner in tort, contract or otherwise, for any special, indirect, incidental, consequential, reliance, statutory, special, punitive or exemplary damages, including, but not limited to, lost profits, loss of use, loss of time, inconvenience, damage to goodwill or reputation, or loss of data, even if advised of the possibility of such damages or such damages could have been reasonably foreseen, in connection with, arising out of, or as a result of, the sale, delivery, servicing, use or loss of use of the products sold hereunder, or for any liability of buyer to any third party with respect thereto.

Obtaining Warranty Coverage or General Inquiries

If coverage is available, you may obtain coverage under this Limited Product Warranty by providing Aquasure with proof of original purchase, and that you are the original purchaser. For service under this Limited Product Warranty, you must notify Aquasure by phone at 1-800-661-0680, by email at support@aquasureusa.com, or in writing at 0000 XXXXXX Dr., City, CA XXXXX. In making the claim, please provide your name, address, phone number, a description of the product involved, and an explanation of the defect.

AQUASURE