



OWNER'S MANUAL

Harmony Series
Whole House Water Softener System



Copyright © 2025 Aquasure. All rights reserved.

This manual, including all text, images, and designs, is the property of Aquasure and is protected by copyright law. No part of this manual may be reproduced, distributed, or transmitted in any form or by any means, including photocopying, recording, or other electronic or mechanical methods, without the prior written permission of Aquasure, except in the case of brief quotations used in critical reviews or articles.

TABLE OF CONTENTS

- 1 WELCOME & CONGRATULATIONS**

- 2 EXTENDED WARRANTY REGISTRATION**

- 3 INSPECTION & PREPARATION**
 - I. System Review and Installation Tools
 - II. Installation Safety Guide
 - III. Installation Diagram

- 7 INSTALLING THE SYSTEM**
 - STEP 1.** Shutting Off the Main Water Supply Valve
 - STEP 2.** Mounting the Control Valve
 - STEP 3.** Connecting the Softener
 - STEP 4.** Connecting the Drain Line
 - STEP 5.** Connecting the Brine Line
 - STEP 6.** Brine Tank Assembly
 - STEP 7.** Flushing and Testing the Plumbing Lines

- 15 SYSTEM INITIALIZATION**
 - STEP 1.** Connect Power to the System
 - STEP 2.** Become Familiar with Display Screen
 - STEP 3.** System Startup
 - STEP 4.** Programming the System

- 20 GALLONS CALCULATION TOOL**

- 25 ADDITIONAL SETTINGS & FEATURES**

- 27 TECHNICAL SPECIFICATIONS**

- 31 LIMITED PRODUCT WARRANTY**

WELCOME & CONGRATULATIONS

Thank you for choosing Aquasure. This owner's manual provides general installation guidance for the Aquasure Harmony Series Whole House Water Softener.

ⓘ IMPORTANT!

This owner's manual serves as general guidance; however, please note that installation errors may cause system malfunctions and may void the warranty. Therefore, we strongly recommend hiring a licensed plumber for professional installation. If you need assistance, our Aquasure technicians are available to answer any questions during business hours, as listed below.



Hours of Operation: M-F 8:30AM - 5:30PM PST

Telephone: 1(800)-661-0680

Email: support@aquasureusa.com

Online Chat: aquasureusa.com/support

GET 5 YEARS OF COVERAGE BY CLAIMING YOUR AQUASURE EXTENDED WARRANTY

Register your product **within 60 Days** from time of purchase to keep your full 5 year warranty. Simply visit aquasureusa.com/support and enter your purchase and serial number, or fill out the information below and follow the steps.

Fill in the information below for future reference and submit using the instructions below to receive the extended 4 year product warranty.

Purchaser Name: _____

Email: _____

Phone: _____

Address: _____

City: _____

State: _____

Zip: _____

Order Number: _____

Order Date: _____

Serial Number: A10 _____

Place of Order: _____

Registration with your mobile device is easy.

1. Fill out the form by handwriting your info.
2. Take a picture of the form with your device.
3. Scan the QR code with your device camera and click the banner that appears.
4. Attach the picture of the form to the email that opens.
5. Hit Send and you're DONE!



INSPECTION & PREPARATION

I. Before Installation: Familiarize Yourself With the System

ⓘ IMPORTANT!

Please read the entire manual and become familiar with instructions and parts needed before proceeding with the installation.

INSPECT THE SYSTEM

Take the system and all the components out of the box and inspect them carefully, making sure nothing was damaged during shipping. If any part is cracked or broken, do not proceed with the installation. Contact Aquasure or your distributor for an exchange or diagnosis.

System Components Breakdown

1. Digital Control Valve
2. Upper Distribution Basket
3. Resin Tank (Pre-filled)
4. Riser Tube & Bottom Distribution Basket (Pre-installed)
5. Thin Profile Hydraulic Meter
6. High Strength Bypass Valve
7. Brine Tank Lid
8. Grid Plate and Risers
9. Brine Tank
10. 6' of 3/8" Brine Line
11. 10' of 1/2" Drain Line
12. Power Adapter
13. Brine Well
14. Float Valve



ⓘ NOTE:

80 lbs Extra Course Grade Salt Pellets are needed to fill the brine tank. The softener system will use any kind of salt formulated for water softener use, but it is advised to use the pellet-shaped salt as it tends to dissolve more evenly. (Potassium can be used for a salt-free alternative)

Required Tool List for System Installation

- Channel Locks
- Screwdriver
- Plumber's Tape
- Utility Knife
- Two Adjustable Wrenches
- Silicone Grease (Lubricant)
- 1" pipe and fittings.
(copper, brass, or PEX or PVC piping)

ⓘ NOTE:

Please note modification to home plumbing may require the use of additional tools.

II. Installation Safety Guide

⚠ WARNING!

For your safety, the information in this manual must be followed to minimize the risk of electric shock, property damage or personal injury.

ⓘ IMPORTANT!

To maintain your warranty, the following feed water conditions must be met. Failure to comply voids the warranty, and the manufacturer is not responsible for any damage to the system or property.

1. Water Temperature Parameter

The system **CANNOT** be installed where it will be exposed to direct sunlight. It must be protected from freezing temperatures and extreme heat.

- Maximum Temperature Exposure: 100° F (37.8° C)
- Lowest Temperature Exposure: 32° F (0° C)

2. Water Pressure Parameter

If daytime pressure is above 80 PSI, nighttime pressure may rise beyond the system's limit. Install a pressure reducing valve (PRV) if needed.

- Maximum: 125 PSI (8.78 kg/cm²)
- Minimum: 25 PSI (1.75 kg/cm²)

3. Chlorine & Chloramine Tolerance

Softener resin can degrade when exposed to chlorine or chloramines. If your feed water contains these disinfectants, it will shorten the resin's lifespan. In such cases, install a whole house carbon filter with media designed to reduce chlorine and chloramines.

- Maximum Level: 2 ppm

4. Pre-install Environment Checklist

- Do not use with microbiologically unsafe water. Pre-filtration is recommended to remove contaminants and heavy sediment for optimal system performance and extended product life.
- System must be properly grounded according to all local codes and ordinances. Use lead-free solder and flux for all sweat-solder connections, as required by state and federal regulations.
- Place the softener in an area where water damage is least likely to occur in case of a leak.
- Install the softener as close as possible to:
 - a. The Pressure tank (for well systems) or water meter (for city water).
 - b. A floor drain or acceptable drain point (such as laundry tub, sump, or standpipe) to prevent air breaks and back flow.
- The brine tank should be located no more than 10' from the resin tank.
- It is recommended to install a Backflow Prevention Device or Vacuum Breaker between the incoming water supply and the system to protect against damage caused by negative pressure.
- Connect the softener to the main cold water supply line before the water heater. Do not run hot water through the softener. Maximum incoming water temperature: 100°F (37.8°C)
- If possible, outdoor faucets and irrigation lines should be supplied with unsoftened water. If this is not an option, bypass the softener when watering grass or plants. Long-term exposure to softened water may harm plant life.
- The system operates on a standard 120V power supply. Use only the included transformer. Do not substitute it with any other adapter.
- A 120-volt outlet must be within 6 feet of the softener. The included transformer has an 8-foot power cord. Ensure both the outlet and transformer are protected from water and moisture.
- For outdoor installations, take proper steps to protect the softener, plumbing, and wiring from weather, debris, and contamination.
- Handle the softener carefully during installation. Do not drop, drag, or place it on sharp or uneven surfaces.
- Plug the transformer into a grounded indoor 120V outlet only.
- Use only clean, high-purity water softening salt (at least 99.5%). Extra coarse grade or crystal salt is recommended. Do not use rock, block, or granulated salts, as these may contain contaminants that could interfere with maintenance.
- Always keep the salt lid securely in place, except when refilling or servicing the system.
- In cases where the installation surface is uneven, the system's floating base allows the tank to be leveled within the base to ensure proper function.

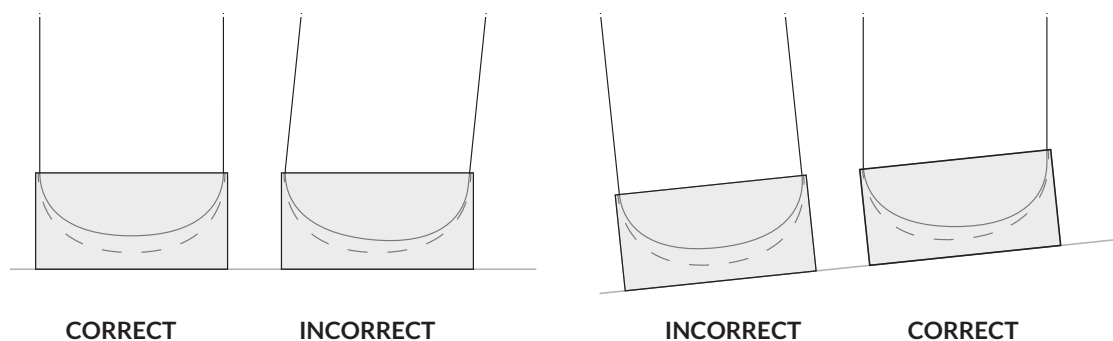

III. Installation Diagram

The diagram below shows a recommended installation layout for both well and city water systems. While plumbing configurations may vary, the core installation principles remain the same. This example includes a pre-filter, media tank, and water softener arranged in proper flow sequence. If your system does not include a media tank or carbon filter, simply omit that component from your installation.

A loop-style installation with shut-off valves, as shown below, is recommended for easier servicing.

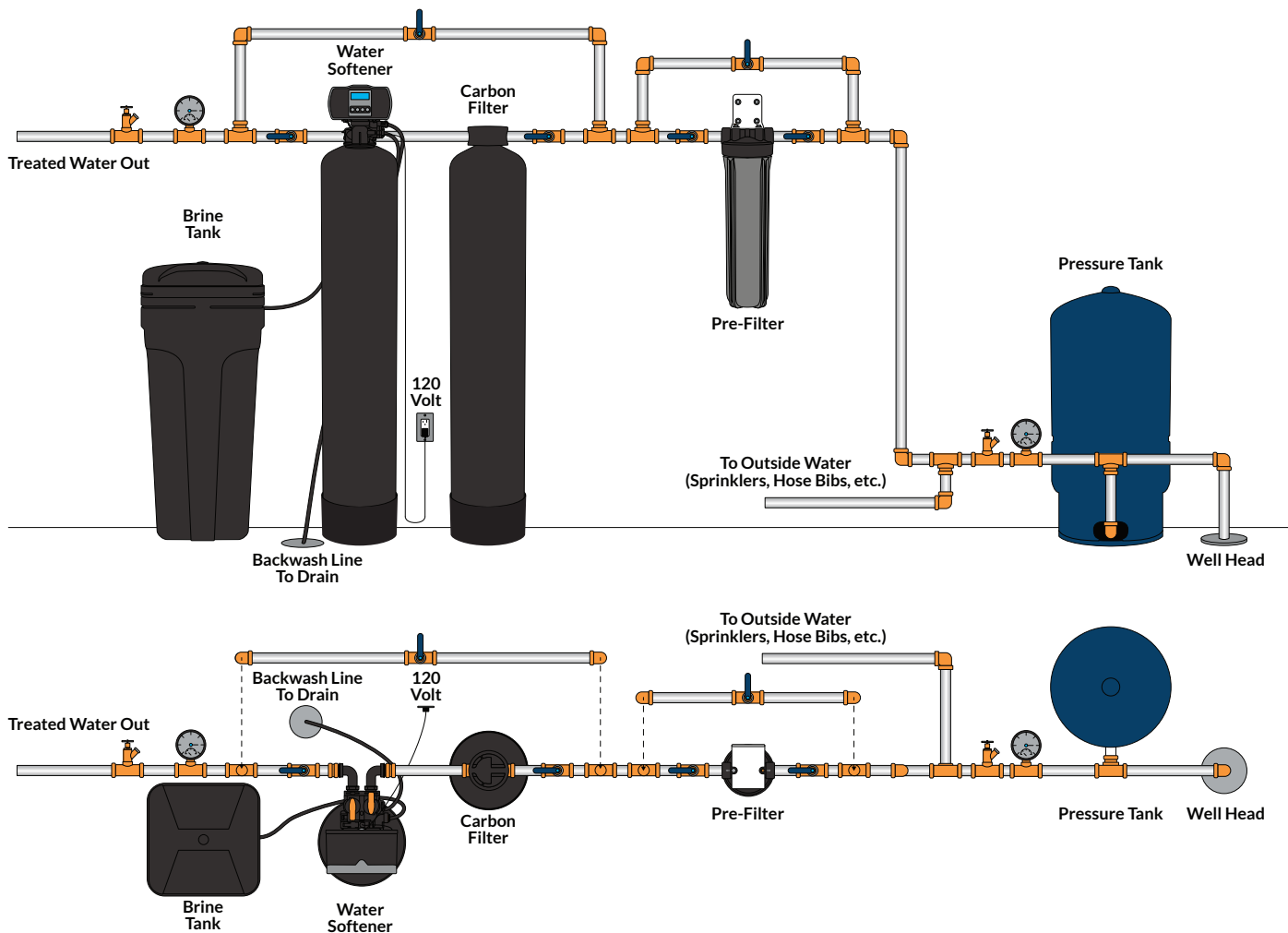

INSTALLING THE SYSTEM

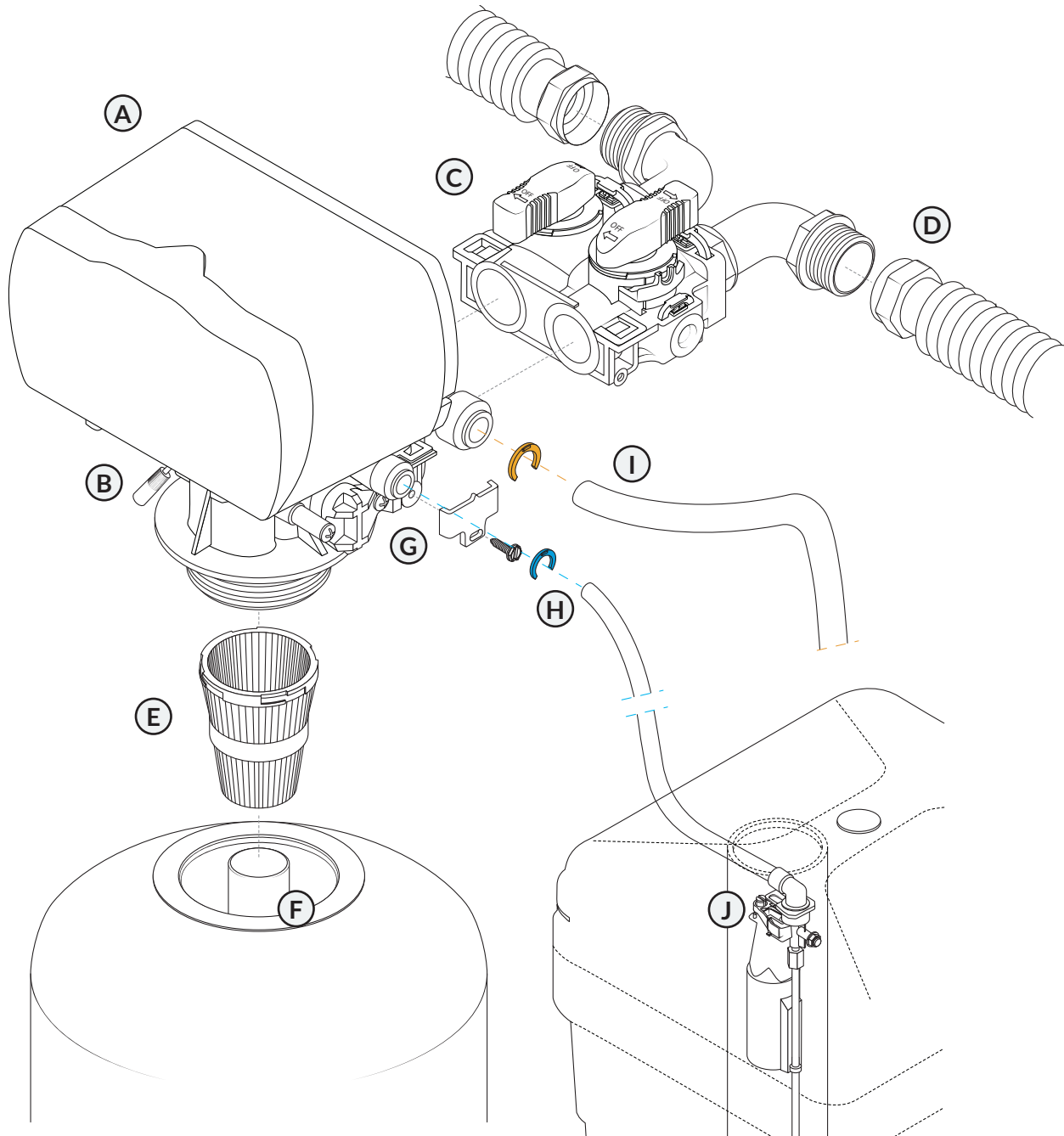

- A. Control Head
- B. Control Head Power
- C. Bypass Valve
- D. Water Connection Hoses (Not Included)
- E. Upper Distribution Basket

- F. Resin Tank
- G. Metal Plates
- H. Brine Line (Blue Clip)
- I. Drain Line (Orange Clip)
- J. Quick Connection (Float Assembly)

STEP 1.

Shut off the Main Water Supply Valve

1. Locate the main water supply valve of the house and turn it off completely by turning the shut-off handle clockwise.
2. Turn on the nearest cold water faucet to confirm the water supply is fully shut off. If water continues to flow, the valve is not fully closed.

ⓘ IMPORTANT!

If the shut-off valve does not completely shut off the water flow, do not proceed. Contact a licensed plumber to repair or replace the shut-off valve before continuing with the installation of the system.

⚠ WARNING!

Do NOT use any electric power tools to tighten or force any components during Step 2. All connections should be hand-tightened only to avoid damaging the system.

STEP 2.

Mounting the Control Valve

1. Lubricate the following parts before installation. Apply silicone grease to:
 - Both O-rings on the bottom of the control valve (inner and outer)
 - The O-rings on the gallon counter.
 - The riser tube located at the tank opening.

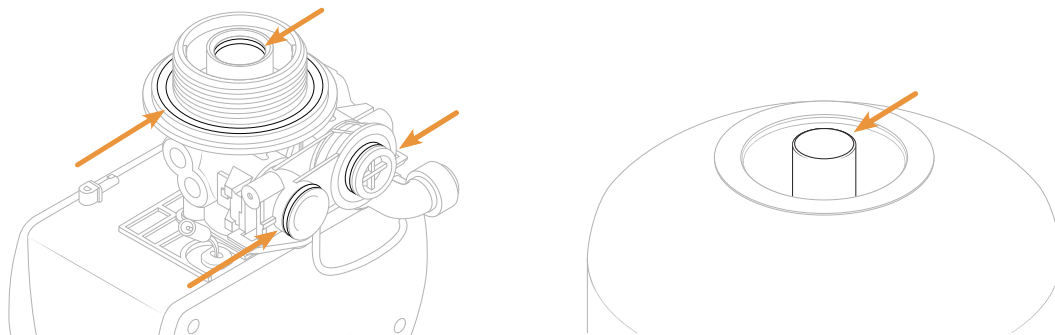

2. Attach the bypass valve to the control head and secure it using the metal plates.

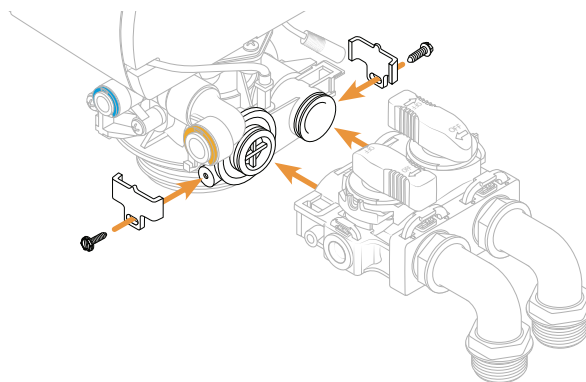

STEP 2.

Mounting the Control Valve (Continued)

3. Install the upper basket on the bottom of the valve by lining up the tabs, pressing in, then turning the basket counterclockwise to lock it in place.

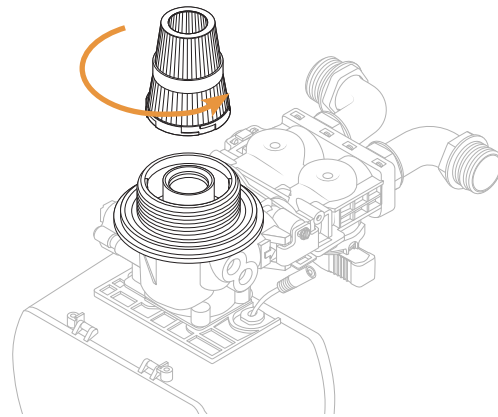

4. Carefully place the control valve (with distribution basket installed) over the distributor tube.
 - Thread the valve clockwise to the tank by hand.
 - Ensure the valve threads easily. If it resists, it may be cross-threaded. Remove and realign.

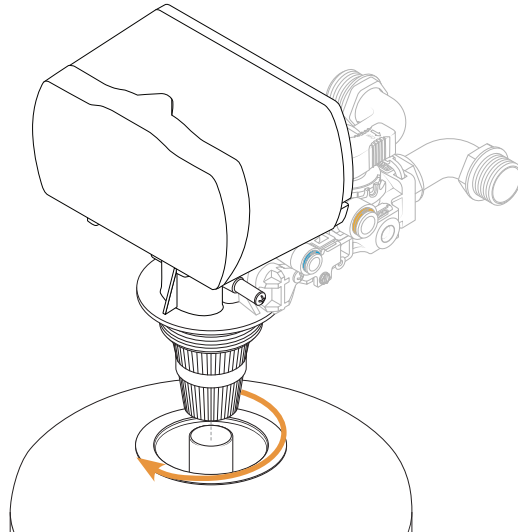

⚠ WARNING!

DO NOT lubricate the threads; this may cause over-tightening.

5. Once hand-tightened, gently tap the valve with the palm of your hand so it fits snugly.

⚠ WARNING!

DO NOT use tools to tighten. Over-tightening may damage the valve or tank.

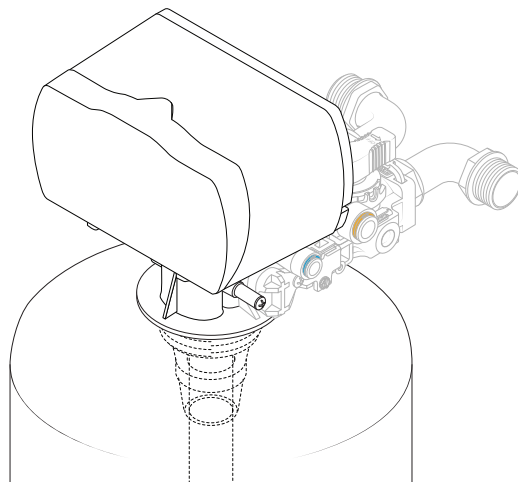

STEP 3. Connecting the Softener

ⓘ IMPORTANT!

For copper plumbing, install a grounding wire between the inlet and outlet pipes to maintain electrical continuity.

⚠ WARNING!

Any solder joints near the valve must be completed before connecting any piping to the valve. When soldering pipes connected to the valve, always leave at least 6 inches (152 mm) of clearance between the valve and the solder joints. Failure to maintain this distance could damage the valve.

1. The control valve has 1" male threaded connections (NPT). Wrap the threads with 8–12 layers of plumber's tape to create a watertight seal when connecting your plumbing.
2. Identify the inlet and outlet using the flow direction arrows stamped on the bypass valve. The arrows pointing toward the valve are the inlet; the arrows pointing away are the outlet.

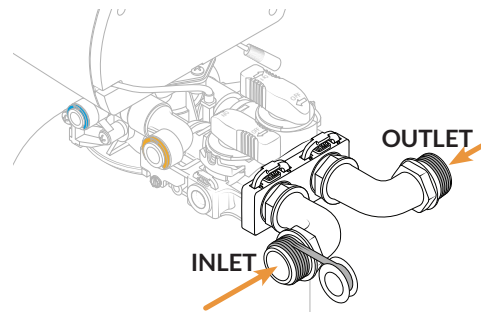

ⓘ NOTE:

The threaded elbows can rotate in order to accommodate your piping.

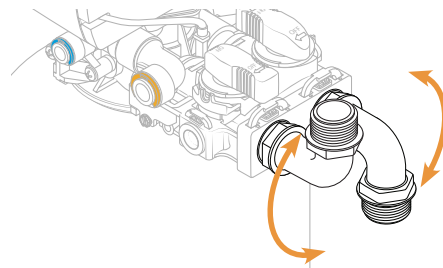

3. Connect the inlet and outlet piping using appropriate fittings.

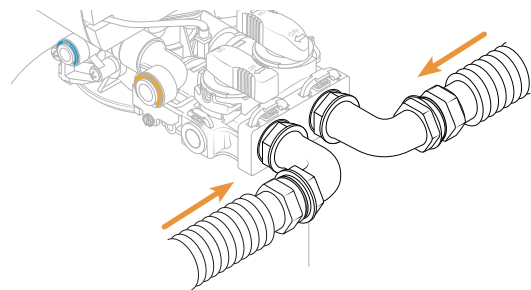

ⓘ NOTE:

Secure all piping to prevent stress or strain on the bypass valve and connectors.

STEP 4.

Connecting the Drain Line

1. Remove the orange locking clip and connect the 1/2" drain line to the control valve.
2. Push the drain line into the connector about 1/2" deep. Reinsert the orange clip, then gently pull to confirm it's secure.

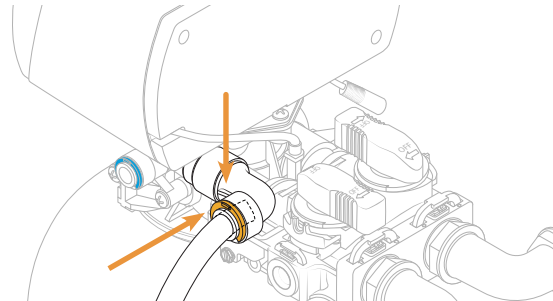
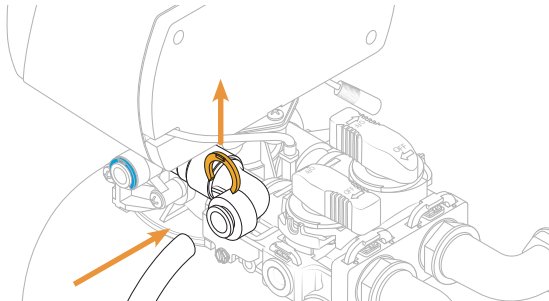

3. Route the drain hose to the nearest laundry tub or floor drain.

ⓘ NOTE:

The drain line can be run a maximum vertical length of 7ft. If the horizontal drain length exceeds 10ft, swap the 1/2" drain line for a 3/4" line extension to prevent backflow issues.

ⓘ NOTE:

Maintain a physical air gap of at least 1.5" between the hose end and the drain to prevent contamination or backflow of wastewater and bacteria.

STEP 5.

Connecting the Brine Line

1. Remove the blue locking clip and connect the 3/8" brine line to the brine port.
2. Push the brine line into the connector about 1/2". Reinsert the blue clip to secure it, then gently pull to confirm it's tight.

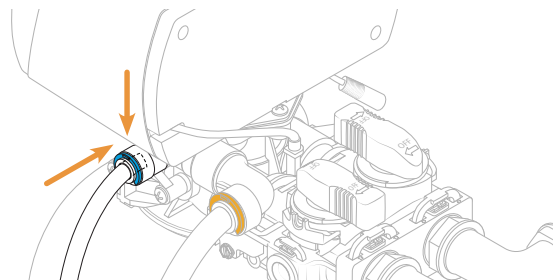
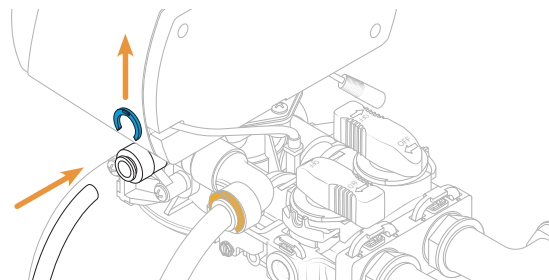

ⓘ IMPORTANT!

If the brine line connection is loose or unsealed, the system may not regenerate properly, which can cause the tank to overfill and leak.

STEP 6. Brink Tank Assembly

NOTE:

The color or design details of certain components may vary slightly from previous versions of this product.

1. Install the Grid Stands:
 - Locate the holes on the grid plate designed for the grid stands. Insert each grid stand into a hole and press down so it locks into place.
2. Position the Grid Plate:
 - After installing the grid stands, identify the remaining open hole in the grid plate. This is for the brine well.
 - Place the assembled grid plate in the brine tank with the brine well hole facing the drain hole.
 - Ensure the stands rest flat on the bottom of the tank and grid plate is level and stable.
3. Install the Brine Well:
 - Insert the brine well into the round opening on the grid plate.
4. Attach the Drain Elbow:
 - Insert the threaded end of the drain elbow through the lower pre-drilled hole on the side of the brine tank.
 - Inside of the tank, slide the drain gasket over the thread of the drain elbow to create a watertight seal.
 - Secure by tightening the nut onto the threaded elbow. Do not over tighten.

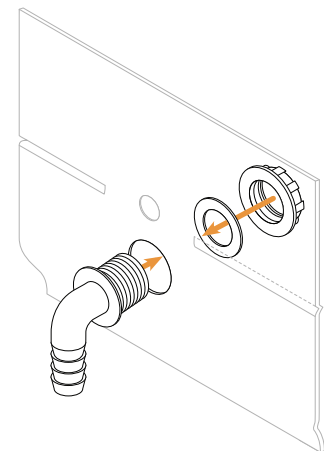
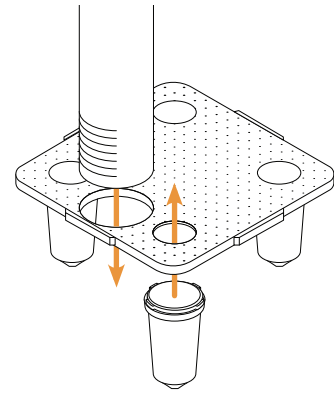

IMPORTANT!

The brine tank overflow connection is optional. It offers extra leak protection. If used, attach a ½" hose to the barbed fitting and run it to a nearby drain.

5. Route the brine line through the hole above the elbow.
6. Thread through the hold in the brine well and connect the brine line to the quick-connect elbow on the float assembly. Push firmly to ensure a secure fit and place the cap on the brine well.
7. Add 80 lbs (two bags) of coarse-grade salt and 5 gallons of tap water into the brine tank.

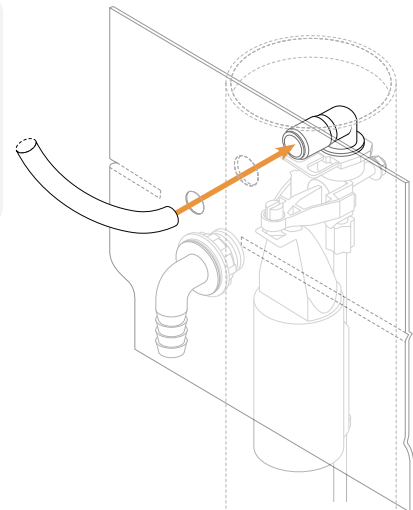

STEP 7.
Flushing and Testing the Plumbing Lines

⚠ WARNING!

If the system is leaking at any point, immediately turn it to bypass mode and shut off the main water supply before inspecting the leak.

📌 IMPORTANT!

Flushing the plumbing lines is essential. It clears out any debris or trapped air, confirms proper plumbing connections, and ensures there are no leaks before startup.

1. Set the unit to the bypass position. Locate the nearest faucet and remove the aerator (faucet screen), if present. Turn on the faucet's cold water and slowly open the main water supply valve. Let water run for a few minutes, or until all air and debris have cleared from the system.
2. Check all plumbing connections for leaks. Once the water runs clear and no leaks are present, turn off the faucet.

**Bypass
Position**

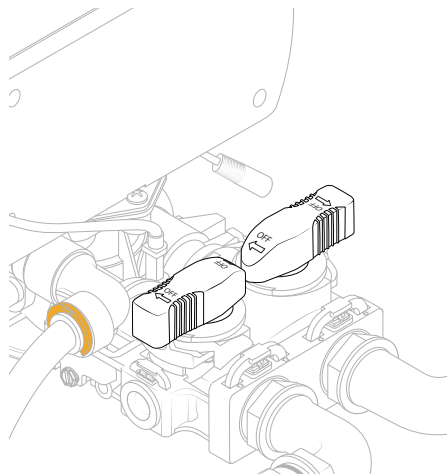

**Service
Position**

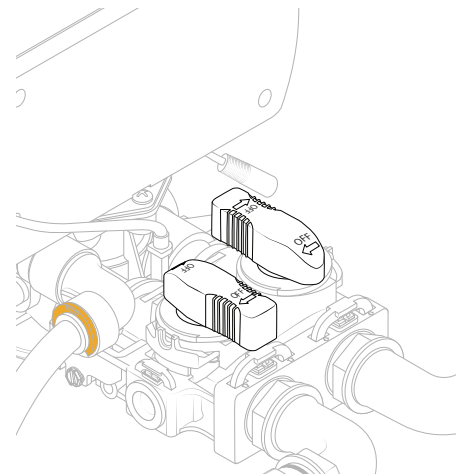

📌 IMPORTANT!

This system is not ready for use until the “System Startup” instructions on page 15 of this manual have been completed.

Complete your Home Water Solution.

Pair your Harmony Water Softener with the Aquasure Premier RO System for pure, great-tasting water straight from the tap. Enjoy the confidence of cleaner, healthier water for cooking, coffee, and drinking.

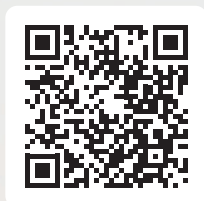

Scan to learn more about our
Drinking Water Filtration Systems.



SYSTEM INITIALIZATION

STEP 1.

Connect Power to the System

1. Connect the power line into the control valve head.
2. Plug the transformer into a 120V outlet.

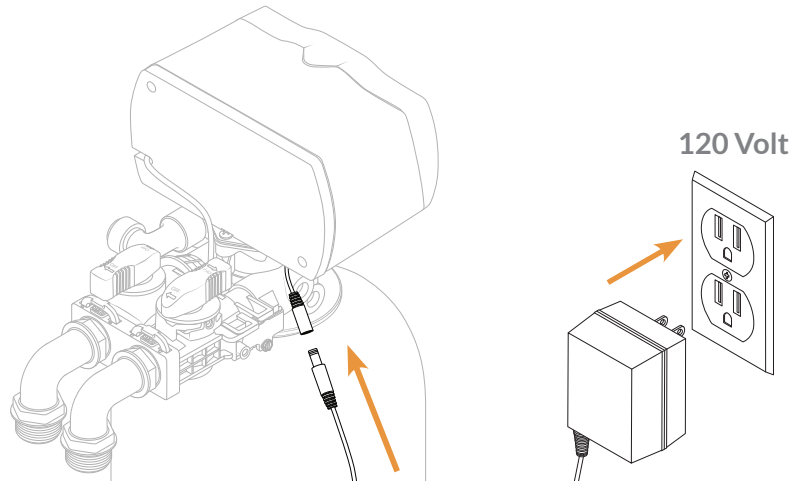

STEP 2.

Become Familiar with Display Screen

ⓘ IMPORTANT!

Each button on the control valve has multiple functions depending on the screen or setting. Some features require pressing two buttons at the same time to activate. Please familiarize yourself with all button operations before using the system.

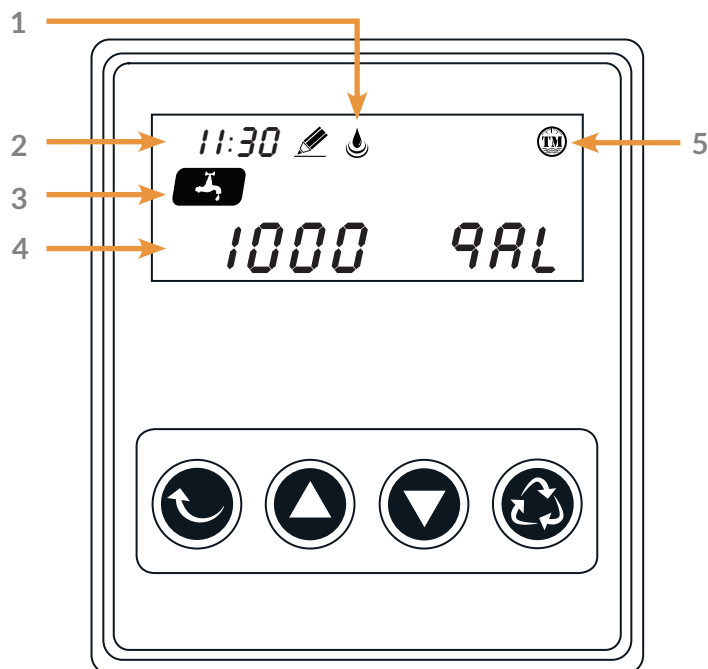

1. Flow Meter Indicator
(Appears when running water)
 2. Time of Day
 3. Status
 4. Volume Remaining
 5. Regeneration Mode
- Ⓜ Time Meter Delay
 - Ⓣ Timer
 - Ⓜ Meter Immediate



ENTER Button



UP / DOWN Buttons





CYCLE Button

⚠ WARNING!

Do Not Unplug The Unit's Power Supply During Regeneration!

To Cancel Regeneration

Press   simultaneously to cancel regenerating. If done correctly, the display will return to the home screen after a few moments.

The display will show as:



📌 NOTE:

Confirm that 5 gallons of water and 80 lbs of salt have been added to the brine tank.

**STEP 3.
System Startup**

1. When power is supplied to the control, the screen will display the time of day, gallons remaining and the regeneration mode. Press and hold the “Cycle” button for 5 seconds until you see the words “9060 5r,” then release the “Cycle” button. The system will begin the backwash (bW) cycle.
2. Once the valve is in the backwash (bW) cycle, you’ll see a 15-minute (015) countdown next to “bW”. Open the inlet on the bypass valve slowly and allow water to enter the unit. If you hear any large “knocking” sounds, turn the red inlet valve partially closed (not all the way) as the water is being fed too quickly and should be slowed. This process will begin to purge air from the resin tank and fill the resin tank with water, allowing the air to escape to the drain line. The water to the drain line will eventually start to run clear after 3-4 minutes.
3. After backwash, the system will enter the brine draw (bD) cycle. This stage lasts 60 minutes total: the brine (saltwater) is typically drawn into the resin tank within the first 20–30 minutes. The remaining time allows the brine to bond with the resin beads
4. Next is the rapid rinse (rR) cycle, which lasts 10 minutes. The rapid rinse (rR) cycle rinses the resin beads thoroughly.
5. When the rinse is complete, the system enters the brine fill (bF) stage. This will refill the brine tank with water. You should see the water level rise to roughly halfway. Let this cycle finish completely.
6. Once regeneration is complete, fully open the outlet side of the bypass valve to allow treated water to flow into the home. Go to the nearest faucet that receives soft water. Remove the aerator screen and turn on the cold water. Let it run until the water runs clear. When done, turn off the faucet and replace the aerator.

STEP 4.
Programming the System



Press “ENTER” and “UP” simultaneously to access the Setting Menu. If done correctly, the screen will switch from the service display (with the faucet icon) to the time-setting screen.

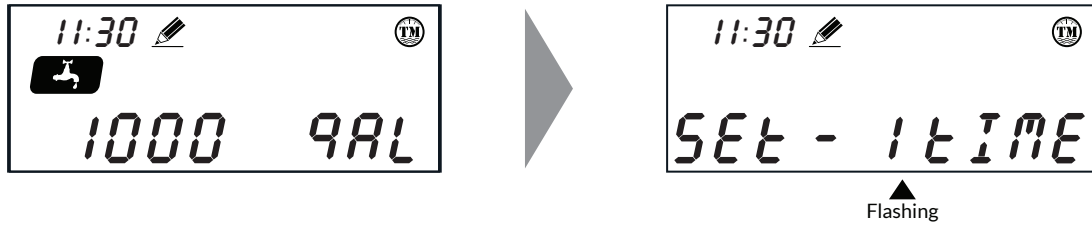

Setting 1 - Time of Day (Military Time)

ⓘ IMPORTANT!
 This system is preset to regenerate at 2 AM based on the time entered during setup. To ensure regeneration occurs at the correct time, make sure the current time is accurately set.

Press ENTER to adjust the time setting.

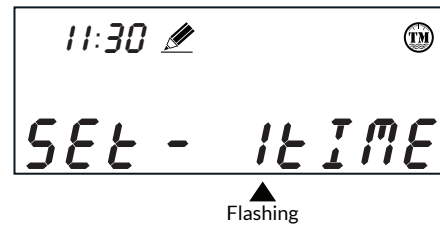

Set the hour

Use the UP or DOWN buttons to change hours.



Press ENTER to confirm and continue.



Set the minutes

Use the UP or DOWN buttons to change minutes.

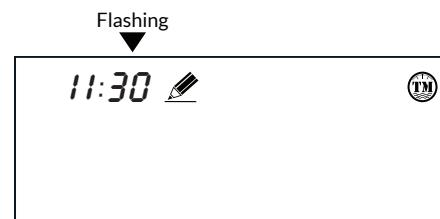

Press ENTER to confirm and continue.



Setting 2 - Regeneration Modes

ⓘ IMPORTANT!

This system has 3 regeneration modes to suit different needs. Leaving your system in Time Meter Delayed (TM) mode is recommended. Time Meter Delayed (TM) mode automatically triggers regeneration at 2 AM on the day after the system's set gallon reaches zero.

Press ENTER to change the regeneration type setting.

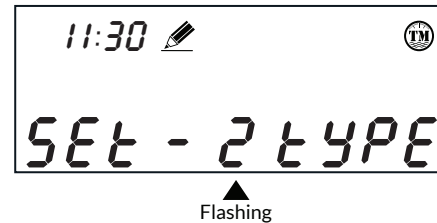

Choose Between Time Meter Delayed, Timer, or Meter

ⓘ NOTE:

It is recommended to keep the system set to Time Meter.



TIME METER DELAYED
Regenerate at 2 am on the day after the set gallon reaches zero.



TIMER
Allows system to regenerate based on a set time interval.



METER
Regenerates immediately after the set gallon reaches zero.

Press Up or Down buttons to change.



Press ENTER to confirm and continue.

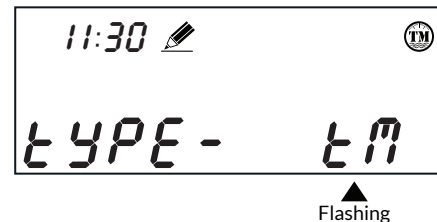

Setting 3 - Unit Capacity (Not shown in Timer Mode)

ⓘ IMPORTANT!

This setting appears only if Meter (M) or Time Meter Delayed (tM) mode was selected, not Timer (t) mode. By default, the system regenerates after softening 1000 gallons of water. You can adjust both the unit of measurement [gallons (GAL) is recommended] and the number of gallons the system can soften before triggering regeneration (also called capacity). Use the worksheet provided on page 19 or Aquasure's online tool (aquasureusa.com/calculationtool) to set the correct capacity.

Press ENTER to adjust the unit capacity setting.

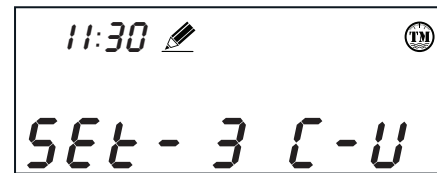

Flashing

Set Unit Measurement - Gallons, Liters or Cubic Meters

(For US Customers, Gallons is the recommended unit setting)

GAL Gallons (Recommended) **L** Liters **M3** Cubic Meters

Press UP or DOWN to change units.



Flashing

Press ENTER to confirm and continue.



Press UP or DOWN to set water capacity.



5 4 3 2 1
Flashing

Press ENTER to confirm. The one on the left should flash if set correctly.



Gallons Calculation Tool

The control valve head uses a meter to track how many gallons of water have been treated. When the programmed gallon limit is reached, the system will regenerate. The total treatable gallons depend on the system size, household size, and water hardness. A simple calculation helps determine the correct gallon amount to enter for the unit capacity.

NOTE:

This calculation must be completed to program the unit:

Total Gallons = System Capacity in Grains (see chart below) / Hardness in (GPG) Grains Per Gallon (determined by water test) - Number of People X 75 Gallons

Parameter	Aquasure Water Softener		
Medium Salt Curve Capacity Setting	24,000 - 40,000	40,001 - 56,000	56,001 - 80,000
Brine Fill Settings in Minutes	8	10	12

Example:

System Capacity: AS-HS32D System/**32,000** Grains (chart above)

Feed Water Hardness: 25 GPG (must be tested on-site by the end user or installer)

Number of People: **3**

$$(\underline{32,000} \text{ Grains} / \underline{25} \text{ GPG}) - (\underline{3} \text{ People} \times 75 \text{ Gallons})$$

$$\underline{1,280} \text{ Gallons} - \underline{225} \text{ Gallons} = \underline{1,055} \text{ Total Gallons}$$

1,055 Gallons would be inputted for Total Gallons during the next step “**Setting 3**” programming. If the hardness level is given in ppm or mg/L, convert to Grains Per Gallon by dividing the value by 17.1. Input the site values in the equation below to figure out your total gallons value:

$$(\underline{\hspace{2cm}} \text{ Grains} / \underline{\hspace{2cm}} \text{ GPG}) - (\underline{\hspace{2cm}} \text{ People} \times 75 \text{ Gallons})$$

$$\underline{\hspace{2cm}} \text{ Gallons} - \underline{\hspace{2cm}} \text{ Gallons} = \underline{\hspace{2cm}} \text{ Total Gallons}$$

ONLINE GALLONS CALCULATION TOOL

Use your phone to scan the QR code below or visit aquasureusa.com/calculationtool for our online gallons calculation tool. If you need further assistance, contact our support team at support@aquasureusa.com.

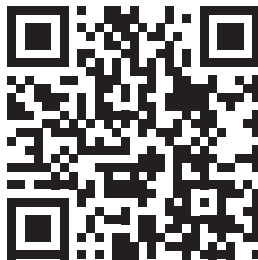

Setting 4 - Regeneration Time and Hours Override

(t) Time Mode

Default Setting: Regenerate every 72 hours at 2 AM

Adjustable Override: You can set regeneration to occur in 24-hour increments up to 960 hours.

Press ENTER to adjust the time and hour override setting.

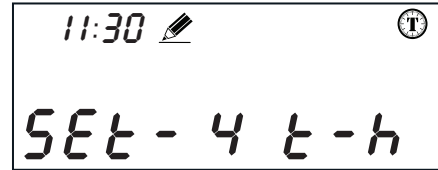

Flashing

Use UP or DOWN buttons to adjust the Regeneration Time.

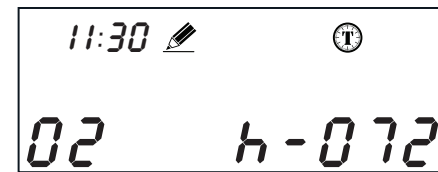

Flashing

Press ENTER to go to Hours Override.

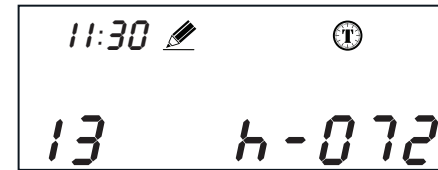

Flashing

Use UP or DOWN buttons to adjust Hours Override.

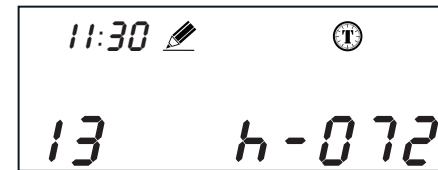

Flashing

Press ENTER to confirm and continue.

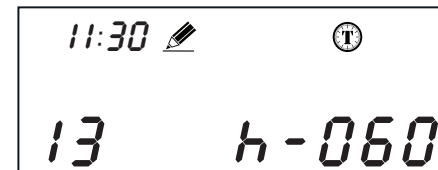

Flashing

❶ **IMPORTANT!**

In some modes, the system defaults to regenerating every 72 hours. Even in Meter (M) or Time Meter Delayed (tM) mode, the override will force the system to regenerate before gallons reach zero. We recommend leaving this setting OFF when using (M) or (tM) mode.

(M) Meter or (tM) Time Meter Mode

Default: 2:00 a.m. – OFF
Hours Override range:
Every 24 hours (24, 48, 72... 960)

Use UP or DOWN buttons to adjust the Regeneration Time.

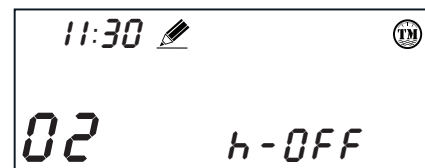

▲
Flashing

Press ENTER to go to Hours Override.

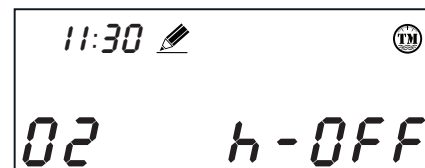

▲
Flashing

Use UP or DOWN buttons to adjust Hours Override.

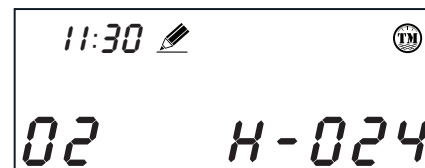

▲
Flashing

Press ENTER to confirm and continue.



❶ **IMPORTANT!**

After setting 4, you can press the  button to return to the main menu. Settings 5–8 are factory-preset and should remain at default unless your water conditions require adjustment. For guidance, contact the Aquasure Support Team at 800-661-0680.

Setting 5 - Setting Back Wash Time (Default Factory Setting Recommended)

Back Wash (**bw**) flushes out any debris or particles from the resin tank. This process also loosens and distributes the resin, creating more surface area for the next stage of regeneration. The factory default is 15 minutes, which works well for most installations.

Press ENTER to adjust the backwash setting.

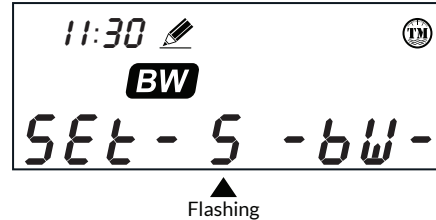

Set the Time

Default setting is 015

Press UP or DOWN to change Back Wash time (Minutes). Range: 0 - 999

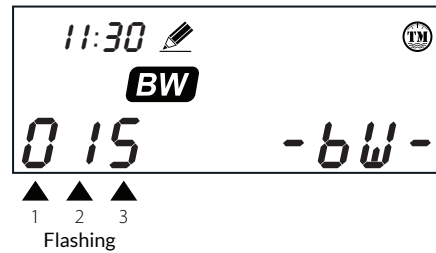

Press ENTER to confirm and continue to the next digit.



Setting 6 - Setting Brine Time (Default Factory Setting Recommended)

Brine draw (**bd**) pulls saltwater from the brine tank into the resin tank. The resin mixes with the brine, restoring its ability to soften water. A longer contact improves regeneration. The default 60 minutes is ideal for most setups.

Press ENTER to adjust the brine draw time.

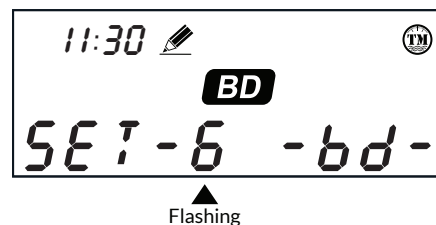

Set the Time

Default setting is 060

Press UP or DOWN to adjust the Brine time. Range: 0 - 999

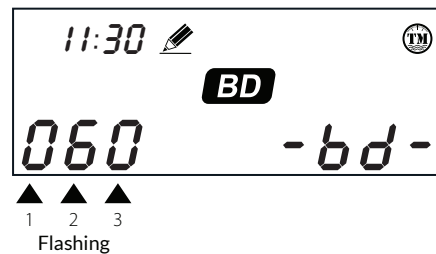

Press ENTER to confirm and continue to the next digit.



Setting 7 - Setting Rapid Rinse Time (Default Factory Setting Recommended)

Rapid Rinse (**rr**) time flushes out leftover hardness and debris from the system to the drain. The factory default is set for 10 minutes.

Press ENTER to adjust the rapid rinse time setting.

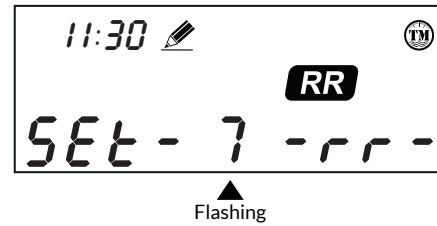

Set the Time

Default setting is **0 10**

Press UP or DOWN to adjust Rapid Rinse time. Range: 0 - 999

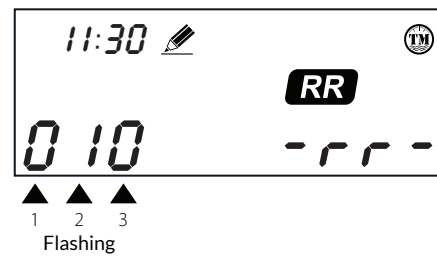

Press ENTER to confirm and continue to the next digit.



Setting 8 - Setting the Brine Fill Time (Default Factory Setting Recommended)

Brine fill (**bf**) time refills the brine tank with water to prepare for the next regeneration. Water levels may vary depending on source water pressure and fill time settings. The factory default time is 12 minutes.

Press ENTER to adjust the brine fill (**bf**) setting.

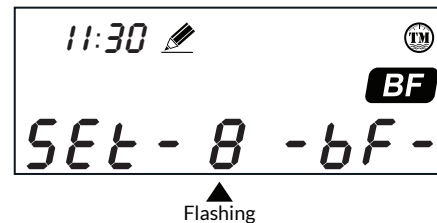

Set the Time

Default setting is **0 12**

Press UP or DOWN to adjust the Water Filling Time. Range: 0 - 999

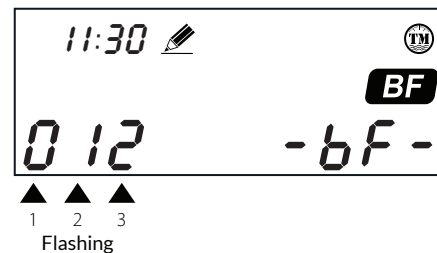

Press ENTER to confirm and continue to the next digit.



ADDITIONAL SETTINGS & FEATURES

1. Service Display Modes

Timed Regeneration Mode

Shows current time, time remaining until the next scheduled regeneration, and any day override settings.

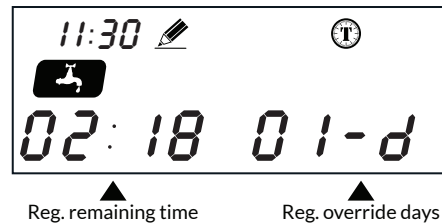

Meter Regeneration Mode

Shows current time and remaining gallons of treated water before regeneration.

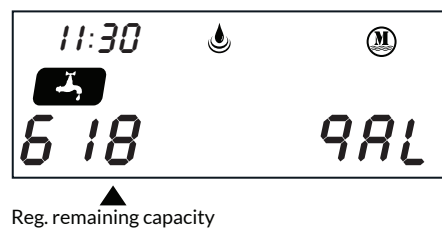

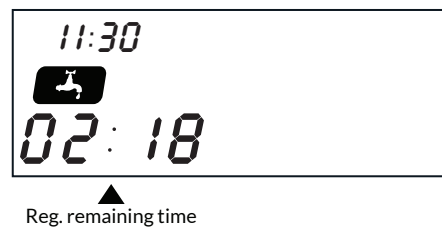

Time Meter Regeneration Mode

Alternates display between current time and remaining gallons of treated water. When gallons reach zero, it switches to a countdown timer until regeneration begins.



2. Restore factory settings

- 1) Disconnect power from the control head.
- 2) Press and hold the  button, then reconnect power.
- 3) Release the  button.

If done correctly, the system will reset and restore factory settings.

Note: It may take a few moments for the display to return to the normal screen.

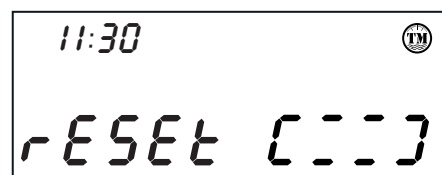

3. Manual regeneration

Queued Regeneration

When the valve is in service position press the  button to activate the queued regeneration. Queued Regeneration means the system will regenerate at the scheduled time. If missed, it will automatically begin the next day.

The display shows the Queued Regeneration in Timer Mode



The display shows the Queued Regeneration in Time Meter Delay Mode

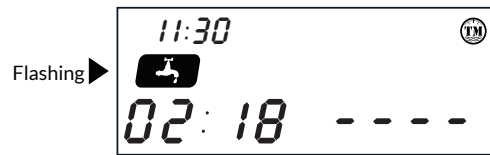

The display shows Queued Regeneration in Meter Delay Mode.

Depending on which happens first, the system will start regeneration when either the remaining treated water reaches zero or the remaining time counts down to zero.



← Alternating Display →



4. Immediate Regeneration

Press and hold the  button for 5 seconds. An immediate regeneration will be initiated.

Your screen will display the following as soon as regeneration begins.



TECHNICAL SPECIFICATIONS

Product Dimensions

Aquares Water Softeners				
Capacity (In Grains)	Tank Size	A (Overall Height)	B (Pipe Install Height)	C (Overall Width)
24K - 32K	8"x44"	52"	44"	8"
33K - 42K	9"x48"	56"	48"	9"
43K - 52K	10"x54"	62"	54"	10"
53K - 72K	12"x52"	60"	52"	12"
80K - 100K	13"x54"	62"	54"	13"



Flow Rate @ 50 psi (3.5 bar) Valve Alone:	
Continuous 15 psi (1 bar) Drop:	20 gpm (76 lpm)
Peak 25 psi (1.7 bar) Drop:	26 gpm (98 lpm)
Max Backwash 25 psi (1.7bar) Drop:	7 gpm (26 lpm)
CV 1 psi (0.07 bar) Drop:	5.0

Regeneration/Backwash:	
Downflow/Upflow:	Downflow Cycles: 5
Adjustable Cycles:	All
Time Available:	Up to 999 minutes per cycle

Meter:	
Accuracy Range:	Turbine Paddle 0.25 - 15 gpm (0.95 - 57 lpm) ± 5%
Capacity Range:	1 - 9,999,999 gal

Valve Specifications:	
Inlet/Outlet:	1" or 3/4", NPT
Mounting Base:	2-1/2" 8 NPSM
Distributor Pilot:	1.05" OD
Drain Line:	1/2" Quick Connect Elbow
Brine Line:	3/8" Quick Connect
Height:	7" (178 mm)
Weight (Valve Gross):	4.84 lb (2.1 kg)

Additional Information:	
Electrical Rating:	Input: 120V AC 60Hz, Output: 24 V DC
Max. VA	3 VA
Water Pressure:	Hydrostatic: 300 psi (21 bar) Working: 20 - 125 psi (1.4 bar - 8.6 bar)
Temperature:	34 - 110 °F (1 - 43 °C)

SYSTEM TROUBLESHOOTING

Scan the QR code below or visit <https://aquasureusa.com/support> to access the latest troubleshooting information. For further assistance, contact our support team at support@aquasureusa.com.



Valve Body Assembly and Parts List

Item No.	Quantity	Part No.	Description
1	3	A-12112	Screw
2	1	A-13546	End Plug Retainer
3	1	A-13363	Washer
4	1	A-13296	Screw
5, 6, 7, 8	1	A-60102-20	Piston Softener & Filter
9, 10	1	A-60125	Seals (5) & Spacers (4) Assy.
11	1	A-61400-34	Valve Body Assembly, 3/4" Dist.
12	4	A-13305	O-ring, Adapter Coupling
13	2	A-19228	Adapter Coupling
14, 15	2	A-13255-FT	Kit Adapter Clip
16	1	A-187706	Yoke, Plastic, 1"
	1	A-187706-02	Yoke, Plastic, 3/4"
17	1	A-13304	O-ring, Distributor Riser Tube
18	1	A-12281	O-ring, Top of Tank
19	1	A-56247	Drain, Quick Connector, Elbow, 1/2" Tubing
20	1	A-01019	O-ring, DLFC
21*	1	A-120XX	DLFC Button
22	1	A-50011	Locking Clip, Drain QC
23	1	A-13245	BLFC Button Retainer
24**	1	A-120XX	BLFC Button
25, 26, 27	1	A-13244	Brine Line Quick Connector 3/8" Tubing
28	2	A-13315	Screw
29	1	A-13166	Injector Cover
30	1	A-13303	O-ring, Injector Cover
31	1	A-01002	O-ring, Injector (Included w/ Injector)
32***	1	A-10225-X-N	Injector
33	1	A-01017	O-ring, Injector (Included w/ Injector)
34	1	A-56226	Screen, Injector
35	1	A-13163	Injector Body
36	2	A-13301	O-ring
37	1	A-13497	Air Dispenser
38	1	A-12638	O-ring
39 - 45	1	A-60032	Brine Valve Assy
46	1	A-13918	BLFC Plug
47	1	A10913BLK-02	Injector Black Capped
48	1	A-13857	Brine Valve Plug

* Extra Option

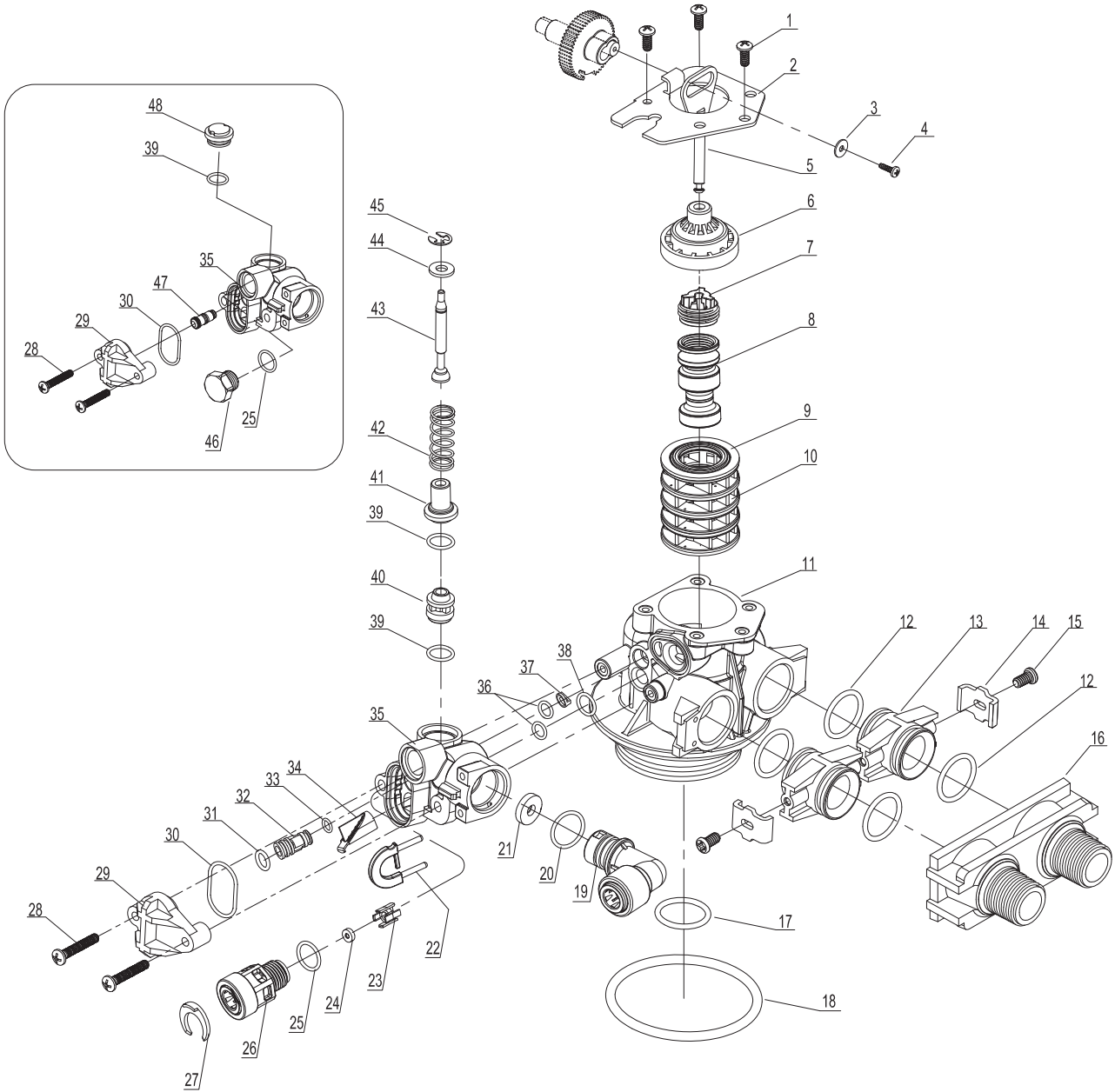

Item No.	Quantity	Part No.	Description
1	1	A-19791-01	Meter Cable, Turbine AQT-565E
2	4	A-13305	O-ring
3	2	A-13255-SE	Adapter Clip
4	2		

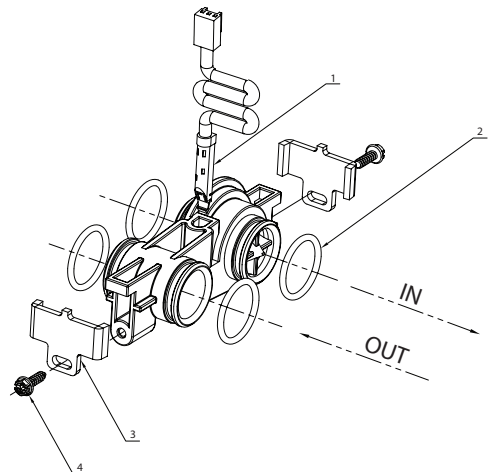

LIMITED PRODUCT WARRANTY

IMPORTANT: THIS IS A PARTS-ONLY WARRANTY. LABOR, INSTALLATION, AND SERVICE COSTS ARE NOT COVERED.

Aquasure warrants to the original retail purchaser that the Harmony Water Softener is free from defects in materials and workmanship. Aquasure will, at its sole discretion, replace any defective products at no charge within the applicable warranty period, starting from the date of original retail purchase. This warranty applies only to the original retail purchaser and only to products purchased new from an authorized Aquasure reseller or distributor. Products that are used, refurbished, or sold as floor models are not eligible for warranty coverage.

If proof of purchase or installation is provided, the warranty period will begin from that documented date.

- One-year warranty on valve, electronics, and resin if product registration is not completed within 60 days of purchase.
- Five-year warranty on valve, electronics, and resin if product is registered with Aquasure within 60 days of purchase.

(See Page 2 of this manual for registration instructions.)

Valve, Electronics and Resin Guarantee:

Aquasure will replace any valve or electronic component determined, with reasonable judgment, to be defective in materials or workmanship. This warranty is limited to replacement of defective parts only and does not include any labor, installation, or service costs. Resin and internal control valve parts are excluded from coverage if the system is used to treat water with iron, manganese, or chlorine levels exceeding the specified operational limits.

General Provisions:

Aquasure is not responsible for incidental, consequential, or other damages, including but not limited to: installation costs, telephone charges, rental of replacement equipment, travel expenses, damage to personal property, loss of revenue, loss of use, loss of time, or inconvenience.

This warranty does not cover defects or damage caused by neglect, misuse, alteration, accident, misapplication, physical damage, fire, freezing, or other environmental factors. Improper maintenance or installation outside the specified requirements will be considered neglect and will void the warranty.

This warranty replaces all other expressed or implied warranties. No representative is authorized to assume additional obligations for the sale of this water softener. Aquasure is not responsible for delays or failure to perform due to strikes, government regulations, or other causes beyond its control.

Obtaining Warranty Service or Inquiries:

If coverage is available, you may obtain coverage under this Limited Product Warranty by providing Aquasure with proof of original purchase confirming that the product was purchased new from an authorized reseller or distributor and that you are the original retail purchaser.

For warranty service under this Limited Product Warranty, you must notify Aquasure by phone at 1-800-661-0680, or by email at support@aquasureusa.com.

SOME STATES DO NOT ALLOW THE EXCLUSION OR LIMITATIONS OF INCIDENTAL OR CONSEQUENTIAL DAMAGES SO THE ABOVE LIMITATION MAY NOT APPLY TO YOU. THIS WARRANTY GIVES YOU SPECIFIC LEGAL RIGHTS, AND YOU MAY ALSO HAVE OTHER RIGHTS WHICH VARY FROM STATE TO STATE.

AQUASURE

Confidence With Each Drop!



SCAN FOR SUPPORT

www.AquasureUSA.com
1(800)-661-0680
support@aquasureusa.com