

AQUASURE

FORTITUDE COMPACT MULTI-PURPOSE UNDER SINK WATER FILTER SYSTEM



OWNER'S MANUAL



*AS-FC50-CKS model shown.

⚠ IMPORTANT!
For optimum performance and protection against contaminants, please fully read this owner's manual before proceeding with installation.

AQUASURE
AQUASURE FORTITUDE COMPACT
MULTI-PURPOSE UNDER SINK
WATER FILTER SYSTEM

 CARBON ▲ Chlorine ▲ Taste ▲ Odor ▲ & More	 KDF ▲ Heavy Metals ▲ Lead ▲ & More	 SILIPHOS ▲ Discoloration ▲ Corrosion ▲ Scale
---------------------------------------------------------------------------------------------------------------------------------------------------	-----------------------------------------------------------------------------------------------------------------------------------------	---------------------------------------------------------------------------------------------------------------------------------------------------

Model Number: AF-FC50-KS
Operating Pressure: 20 - 75 PSI
Operating Temperature: 33°F - 105°F
Filter Life: 12 - 18 Months*

*Filter lifespan may vary due to the condition of the source water.

Scan to order Aquasure certified replacement filters.



(800) 661-0680
www.aquasureusa.com
support@aquasureusa.com
EPA Est. 103282-TWH-1

WELCOME & CONGRATULATIONS

Thank you for choosing Aquasure. This owner's manual will guide you through the necessary steps to fully self-install the Fortitude Compact Water Filtration System.

For MAXIMUM effectiveness please thoroughly read this manual.

The information listed in this manual covers the steps for a self-serve installation. In the event that you need support, our Aquasure technicians are available to answer any questions during hours of operation as listed below.

Telephone:

(800) 661-0680
M-F 8:30AM - 5:30PM

**Scan the QR code
for support**



Email:

support@aquasureusa.com

Online Chat:

aquasureusa.com/support

Get Familiar with the System Before Installation

IMPORTANT! Please read the entire manual and become familiar with instructions and parts needed before proceeding with the installation. Hiring a professional plumber who will adhere to all local, state and federal guidelines is recommended for a proper installation.

Inspect the System

Please take the system and all the components out of the box. Inspect the system and all the connection fittings carefully, make sure nothing is damaged during shipping. If any part is cracked or broken, please do not proceed with the installation and contact Aquasure or your distributor for an exchange or diagnosis.

TABLE OF CONTENTS

System Components	2
Installation Checklist	3
System Installation.....	4
System Startup.....	6
System Maintenance.....	7
Replacement Filters	8
FAQs.....	9
Warranty.....	10
Notes	12

Thank you for choosing Aquasure. Before you start using your Aquasure system, take a few minutes to become familiar with the basics.

IMPORTANT

Filter replacement: Be sure to change your Aquasure water filters according to the recommended filter replacement schedule. This helps keep your Aquasure drinking water system running in top condition.

Register your system within 60 days and extend your warranty for an additional two years of coverage

Help expedite any support needed and also receive additional 2 years of limited warranty by registering your system online at www.aquasureusa.com/support or scan the QR code

Scan to register your system



Included:

- Fortitude System Head
- Fortitude Compact Filter
- Owner's Manual
- Installation Hardware
- 3/8" NPT Stainless Steel Braided Line 18" x 2
- 3/8" to 1/2" Stainless Steel Adapter x 2
- Maintenance Reminder

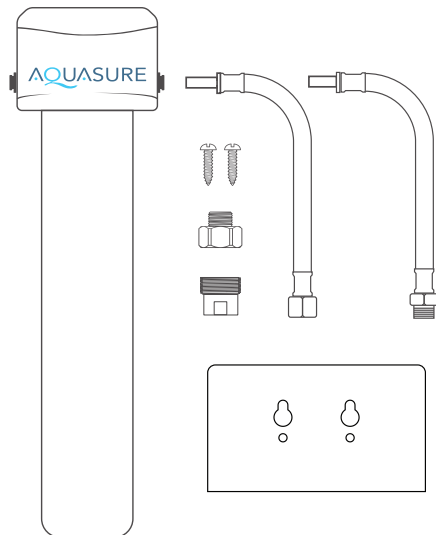

System Operation Parameters and Installation checklist

IMPORTANT! The following conditions for the feed water supply must be met or warranty will be void and manufacturer assumes no responsibility for damage to system or property.

1. Water Temperature Parameters

- Maximum: 105° F (40.6° C)
- Minimum: 33° F (0.55° C)

WARNING: Do not allow the system to freeze, the filter always contains water and will be destroyed if frozen. Do not plumb system to hot water, The tubing will expand or burst, and filter will be destroyed which will void warranty and manufacturer's responsibility.

2. Water Pressure Parameters

- Maximum: 75 PSI (5.27 kg/cm²)
- Minimum: 25psi (1.76 kg/cm²)

WARNING: This system is designed to operate at a water pressure in the range of 25 PSI to 75 PSI (1.76 kg/cm² to 5.27 kg/cm²). Operating at a pressure lower than the minimum required PSI will result in lower quality and quantity of product water. Operating at a pressure higher than the maximum allowed PSI will cause severe damage to the system.

WARNING: Do not proceed with the installation until water pressure is confirmed to be lower than 75 psi. A pressure regulator must be installed on the feed water source coming into the home to reduce water pressure going into the system and ensuring water pressure does not exceeds 75 psi.

3. Water Condition Parameters

- Turbidity: <5 NTU
- pH: 4 - 11
- Hardness: < 7 grains per gallon (< 120 ppm)
- Sulfide, Iron Manganese: < 0.01 ppm
- Chlorine: < 2 ppm
- Total Dissolved Solids (TDS): < 1,000 ppm

4. Pre-install environment checklist

- Installation needs to comply with state and local laws and regulations.
- System must be installed indoor away from possible environmental damage
- Do not use with water that is microbiologically unsafe or of unknown quality without adequate disinfection before or after the system. Systems certified for cyst reduction may be used on disinfected water that may contain filterable cysts.
- The system is best installed under the kitchen sink. But if that is not feasible, you can install the system anywhere where there is a cold water supply with sufficient water pressure.

SYSTEM INSTALLATION

Step 1: Attach the system to the mounting surface

1. Apply the mounting guide to the desired mounting surface. Use the label as a guide for the screw installation or drill location.
2. Place the system head with the filter attached on the mounting surface. Be sure to reserve enough clearance on the bottom for removing and replacing the filter.
3. Hang the system using the installation screws.

(Important: Mount the water filter at least 2 inches higher than the ground for an easier filter change.)

(Important: Make sure to install the system in a location where the connection to the cold water line and faucet is within reach of the hoses provided.)

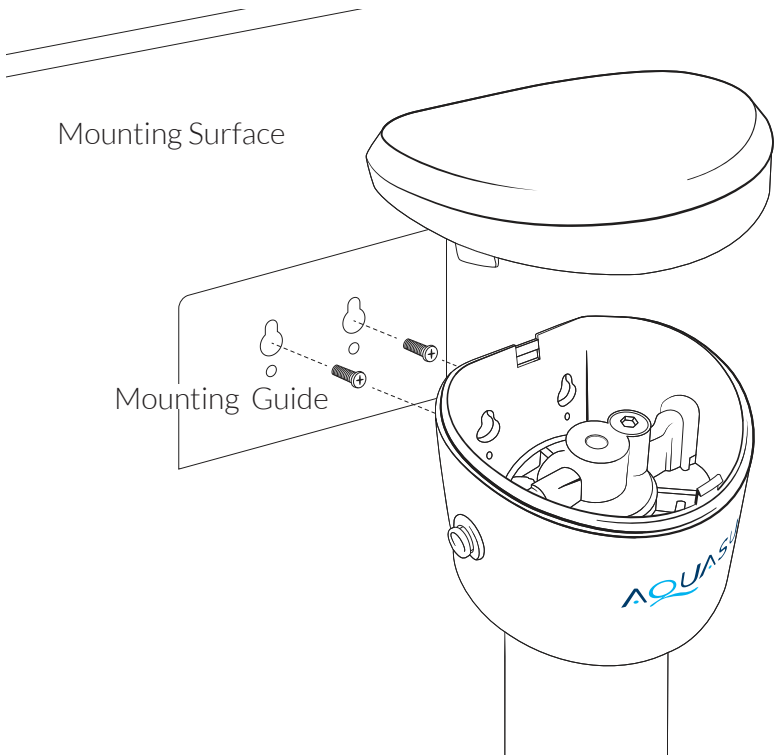

Step 2: Connect the water filter system

Caution! open the faucet to the cold water side to test if the water is shut off. If the water is not shut off, you may have shut off the hot water valve instead, or your water valve is defective. If your water valve is defective, you will need to shut the main water line off before proceeding with the installation.

1. Shut off the cold water valve
2. Disconnect the existing cold water line from the cold water valve. (Some water may leak, use a dry microfiber cloth to wipe off excessive water.)
3. Disconnect the existing cold water line from the faucet connection.
4. Connect the inlet hose with the Female NPT connection to the Cold Water Valve.

Important! If your cold water connection is 1/2" Please installed the included 3/8" to 1/2" stainless steel adapter onto the cold water valve and the faucet connection first. Apply Teflon tape where necessary.

5. Connect the outlet hose with the Male NPT connection to the Faucet connection.
6. Connect the quick connection side of the inlet hose to the system head that shows in.
7. Connect the quick connection side out the outlet hose to the system head that shows out.
8. Locate the system head in and out port
9. Connect the inlet hose with the female NPT side to the cold water valve.
10. Connect the outlet hose with the male NPT side to the faucet connection.

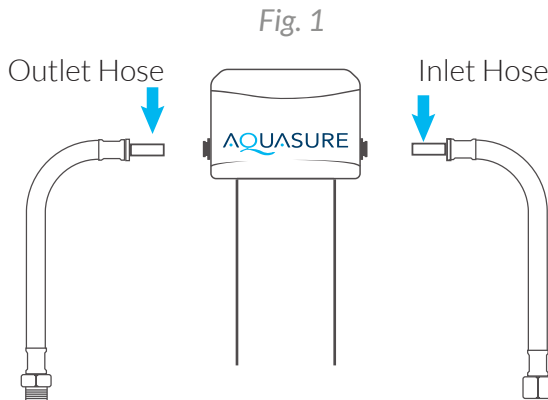

SYSTEM STARTUP

Check the leaks and flush the filter

1. Slowly turn on the cold water valve to allow water to go through.
2. If water leakage occurs, turn off the water supply.
3. Wrap Teflon tape if the leak is happening at a threaded source. Such as the faucet hose connection or cold water valve connection. Or check the connections on either side of the filter system and make sure they are fully inserted.
4. Check again for leaks.
5. Turn on the faucet on the cold water side, and let the water run for 5 minutes to flush the filter before use.

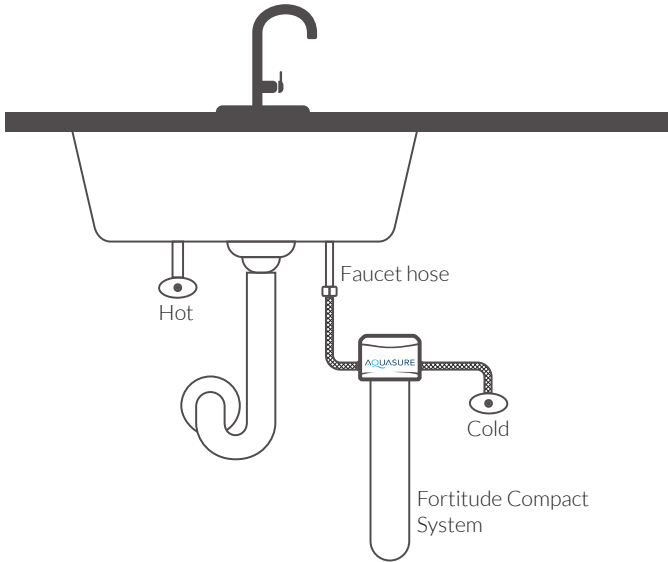

SYSTEM MAINTENANCE

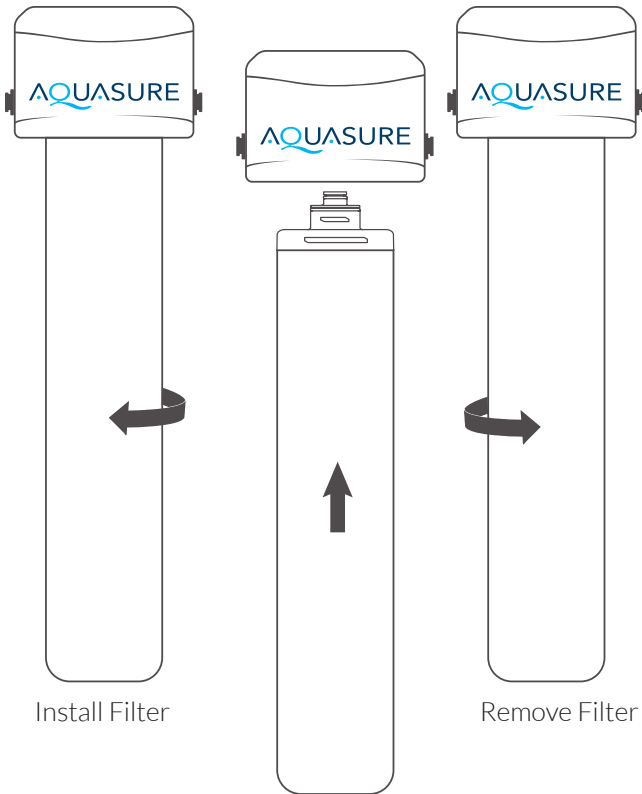

Replacing the filter

1. Turn off the cold water valve supply and turn on the faucet to release any remaining water pressure.
2. Hand rotate the filter to the right a quarter turn or until it stops. Remove the filter from the system head.
3. Remove the protective cap from the new replacement filter.
4. Insert the new filter into the system head and hand rotate the filter to the left a quarter turn or until it stops.
5. Turn on the cold water valve and turn on the faucet on the cold water side to let it flush for 5 minutes before use.

SUBSCRIBE AND SAVE

Never worry again when it's time to replace your filters.

Save time and money when replacing your Fortitude Compact Water filters with our Subscribe and Save program!

Get 25% off your first order and then 10% off each order after that.

Signing up is easy...

1. Scan the QR code on the bottom OR go to aquasureusa.com/subscribeandsave
2. Select your replacement filters
3. Choose when you want to receive your new filters

That's it!

Cancel or change your delivery frequency at any time.

Scan to order replacement filters



Frequently Asked Questions

What should I do if water leaks after installation?

In the event of water leakage, turn off the water supply. If the water leakage is occurring at the thread, wrap Teflon tape on the external thread. If the water leakage is occurring at the quick connection position, insert the quick-connect fitting to the end and make sure the hoses hit the bottom of the fitting.

Why doesn't the TDS value lower after filtration?

The main purpose of this filter is not to remove TDS. TDS stands for total dissolved solids and it is basically composed of inorganic salts and a small amount of organic matter. The filter can remove harmful substances while keeping beneficial trace elements. If removal of TDS is needed please choose our Aquasure Premier Reverse Osmosis Systems.

When should I replace the filter?

The filter's service life is related to the water quality. If the flow rate is significantly reduced or if the water has a peculiar smell, we suggest that you replace the filter. If using Fortitude Compact with Anti-Rust media an indicator of the filter needing to be replaced can be the return of scale to your fixtures.

Why does black water come out during flushing?

It's normal that black water comes out when flushing. The purpose is to remove carbon powder remaining on the surface of the filter materials. You can normally use it after flushing for 5 minutes.

MANUFACTURER'S WARRANTY

1-YEAR LIMITED WARRANTY

For AQUASURE Fortitude Drinking Water Filter Systems

AQUASURE Fortitude Compact Water Filter Systems warrants product to be free from defects in material and workmanship for a period of twelve (12) months from the date of purchase. During this time, we will repair or replace, at its option, any AQUASURE Fortitude Compact Water Filter System. Please request and RMA and upon RMA approval return the AQUASURE Fortitude Compact Water Filter System and we will either make the necessary repairs or, if it is determined that a replacement is required, we will provide a replacement part. This warranty does not include shipping and handling charges which will be collected from you by the dealer. Parts repaired or replaced under this one (1) year warranty will be covered under warranty to the end of the original one (1) year warranty period. This warranty is also subject to the conditions and limitations outlined under the heading "General Conditions and Limitations" section.

ONE-YEAR LIMITED PRORATED WARRANTY

For Structural, Hardware and Electrical Components

AQUASURE Fortitude Compact Water Filter Systems warrants the structural, hardware, and any electrical components to be free from defects in material and workmanship for a period of one (1) year pro-rated from the date of purchase. During this time, we will repair or replace, at its option, any defective parts covered by the warranty. Defective part(s) will need to be returned to AQUASURE. We will either make the necessary repairs or, if it is determined that a replacement is required, we will provide a replacement part. We will then return the part to the buyer. This warranty does not include shipping and handling charges which will be collected from you. Parts repaired or replaced under this one (1) year pro-rated warranty will be covered under warranty to the end of the original one (1) year prorated warranty period. This warranty is also subject to the conditions and limitations outlined under the heading "General Conditions and Limitations" section.

One-Year Limited Warranty for fittings, tubing, valves, flow-lok and shok blok.

AQUASURE Fortitude Compact Water Filter Systems warrants these parts to be free from defects in material and workmanship for a period of one (1) year from the date of purchase. During this time, we will repair or replace, at its option, any defective parts covered by the warranty. The warranty may be verified using date codes in addition to purchase receipts and AQUASURE Fortitude Compact Water Filter System's database of serial number sales date. We will advise you whether the defective item needs to be returned to the AQUASURE Fortitude Compact Water Filter Systems dealer you purchased the equipment from for failure analysis. Replacement parts provided under warranty will be sent to your AQUASURE Fortitude Compact Water Filter Systems dealer. Parts replaced under this one (1) year warranty will be covered under warranty to the end of the original one (1) year warranty period. This warranty is also subject to the conditions and limitations outlined under the heading "General Conditions and Limitations" section.

General Conditions and Limitations

None of the above warranties cover damage caused by improper use or maintenance, accidents, acts of God or minor scratches or imperfections that do not materially impair the operation of the product. The warranties also do not cover products that are not installed as outlined in the applicable Owner's Manual. AQUASURE Fortitude Compact Water Filter Systems warranty will be deemed null and void if any of the product labels are removed. The limited warranties described above are the only warranties applicable to the AQUASURE Fortitude Compact Water Filter Systems products. These limited warranties outline the exclusive remedy for all claims whether based on contract, tort (including negligence), strict liability or otherwise. Disclaimer of warranties. Except as expressly warranted in writing by, the goods sold by AQUASURE are purchased by the buyer "as is." AQUASURE does not warrant that the goods are of merchantable quality or that they can be used for any particular purpose. Except as expressly warranted in writing by AQUASURE, AQUASURE makes no representation or warranty of any kind with respect to the products.

Non-Covered Defects

THIS LIMITED PRODUCT WARRANTY DOES NOT COVER DEFECTS CAUSED BY:

1. Improper storage, installation, maintenance, handling, use and/or alterations of the Product, including, but not limited to, noncompliance with the installation, maintenance and standard operation conditions stated in the Manual and this Limited Product Warranty.
2. Unreasonable use, unintended use, or misuse of the Product for something other than its intended purpose as a drinking water system.
3. Use of replacement parts, filters, membranes or other accessories that are not sold or manufactured by Aquasure for use with this particular Product.
4. Damage not resulting from manufacturing defects that occur while the Product is in the original purchaser's possession.
5. Installation of the Product with known or visible manufacturing defects at the time of installation.
6. Damage caused by freezing, flood, fire or Act of God.

Condition that render this limited product warranty void

THIS LIMITED PRODUCT WARRANTY SHALL BE VOID IF:

1. The Product is not operated in compliance with normal municipal water conditions for which the particular model of this Product is intended.
2. The person seeking to invoke the warranty is not the original purchaser. That is, this Limited Product Warranty only extends to original purchasers.
3. The product is purchased used. That is, this Limited Product Warranty only covers new products.
4. The Product is purchased from someone other than Aquasure or one of Aquasure's authorized dealers. This is because, unless the Product was sold by Aquasure or one of its authorized dealers, Aquasure cannot verify or guarantee the integrity or authenticity of the Product.

Limitation of liability.

In no event shall AQUASURE be liable to the purchaser or any other entity for more than the invoice price received by AQUASURE for any non-conforming products. AQUASURE shall not be liable to the purchaser or any other entity for personal injury, property damage, or any direct, indirect, special, incidental, consequential, punitive, exemplary, or other damages of any kind, including without limitation the cost of procurement of substitute goods, the loss of profits, products, or production, or the interruption of business, however caused and on any theory of liability, and whether or not AQUASURE has been advised of the possibility of such damages. The essential purpose of this provision is to limit the liability of AQUASURE arising out of the sale of products to the purchaser whether for breach of contract, negligence, or otherwise. These limitations shall apply notwithstanding any failure of essential purpose of any limited remedy and notwithstanding the provisions of any other agreement between AQUASURE and the purchaser.

Obtaining Warranty Coverage or General Inquiries

If coverage is available, you may obtain coverage under this Limited Product Warranty by providing Aquasure with proof of original purchase, and that you are the original purchaser. For service under this Limited Product Warranty, you must notify Aquasure by phone at 1-800-661-0680, by email at support@aquasureusa.com, or in writing at 5015 Hallmark Pkwy San Bernardino CA 92407. In making the claim, please provide your name, address, phone number, a description of the product involved, and an explanation of the defect.

AQUASURE